

# PLASTIC PUSH-IN FITTINGS

PLUS

## COMPLETE RANGE

thanks to a 20-years experience in the market.

## HIGHEST LEVEL OF PERFORMANCES

working pressure up to 16 bar, increased of working temperature.

**PLASTIC STEM SYSTEM** to allow the connection with different kind of fittings.

## MADE BY TOP QUALITY

**TECNOPOLYMERS** to guarantee long-lasting components.

## 100% LEAK-PROOF TESTED

## SILICON FREE MATERIALS

## IN COMPLIANCE WITH ISO 14743

## SUITABLE FOR VACUUM APPLICATIONS

**STATIC GRIPPING SYSTEM** in order to stop all the movements of the tube when inserted, granting a leak-proof connection

## Every fitting is STUDIED TO GUARANTEE THE MAXIMUM POSSIBLE FLOW

**RATE** accordingly to the diameter of the tube and to the thread







p. 32 / **WTRY**



p. 32 / **WTRY-N**



p. 32 / **WTRW**



p. 33 / **WTRW-N**



p. 33 / **WTRZA**



p. 33 / **WTRZA-N**



p. 33 / **WTRK**



p. 34 / **WTRK-N**



p. 34 / **WTRKG**



p. 34 / **WTRKG-N**



p. 34 / **WTRGJ**



p. 35 / **WTRGJ-N**



p. 35 / **WTRLJ**



p. 35 / **WTRLJ-N**



p. 35 / **WTRLGJ**



p. 36 / **WTRLGJ-N**



p. 36 / **WTRYJ**



p. 36 / **WTRYJ-N**



p. 36 / **WTRWJ**



p. 37 / **WTRWJ-N**



p. 37 / **WTRKJ**



p. 37 / **WTRKJ-N**



p. 37 / **WTRPF**



p. 38 / **WTRIJ**



p. 38 / **WTRIJ-N**



p. 38 / **WTRIG**



p. 38 / **WTRIG-N**



p. 39 / **WTRP**



p. 39 / **WTRP-N**



p. 39 / **WTRUC-PRD**



p. 39 / **WTRCV**



p. 39 / **TR**







-20°C ÷ 80°C



Working pressure:  
16 Bar  
Negative pressure:  
-750 mmHg



Compressed air & vacuum



Taper gas BSPT ISO 7  
from R1/8" to R1/2" with teflon  
Parallel gas BSPP ISO 228  
from G1/8" to G1/2"  
Metric ISO 262 M5, M6, M7  
NPT from N1/8" to N1/2"  
UNF 10-32



Polyamide PA,  
Polyurethane PU,  
Polyethylene PE



**Body:** Nickel plated brass  
and high performance PBT  
**Release Sleeve:** Acetal resin POM  
**Cartridge:** Nickel plated zinc  
**Lock claw:** Stainless steel AISI 301  
**Back Ring:** POM  
**O'ring:** NBR silicon Free  
**V-Seal:** NBR silicon Free



Products in compliance with  
the directive 2002/95/EC

### RoHS2

Products in compliance with  
the directive 2011/65/EU

### INSERTION OF THE TUBE INTO THE FITTING

- Make sure the tube is fully inserted into the fitting.
- To insert the tube into the fitting cut the tube at a squared angle (90°), insert up to the end and pull gently to make sure it is correctly connected.
- If there are any damages or scratches on the tube surface or an oval shape, air leakage and tube release may occur. Check it carefully.
- The OD of polyurethane tubes expand when pressure is applied. Reinsertion into the fitting may not be possible. Check the OD of the tube and change the tube if the expansion is serious.
- Always remove by cutting the part of the tube previously inserted into the fitting. Use a proper tube cutter in order to cut the tube.

### DISCONNECTION OF THE TUBE FROM THE FITTING

- Make sure the pressure is zero before releasing the tube from the fitting.
- To release the tube, press the release ring regularly at the end and pull the tube with one hand.

### CONSTRUCTION MATERIALS

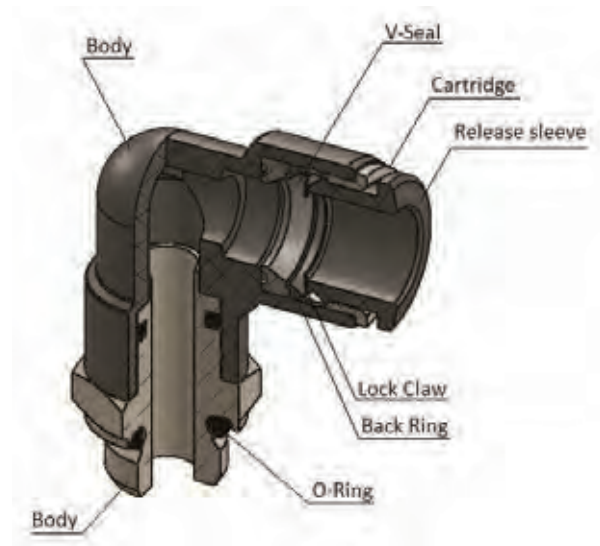

### TOLERANCE TUBE

TUBES Ø	Ø 4 mm	Ø 6 mm	Ø 8 mm	Ø 10 mm	Ø 12 mm	Ø 14 mm	Ø 16 mm
TOLERANCES (MM)	± 0,1	± 0,1	± 0,1	± 0,15	± 0,15	± 0,15	± 0,15

  

TUBES Ø	Ø 5/32	Ø 3/16	Ø 1/4	Ø 5/16	Ø 3/8	Ø 1/2
TOLERANCES (INCH)	± 0,003	± 0,003	± 0,003	± 0,003	± 0,005	± 0,005



**WTRC-R**

Male connector with internal hexagon BSPT thread nickel plated

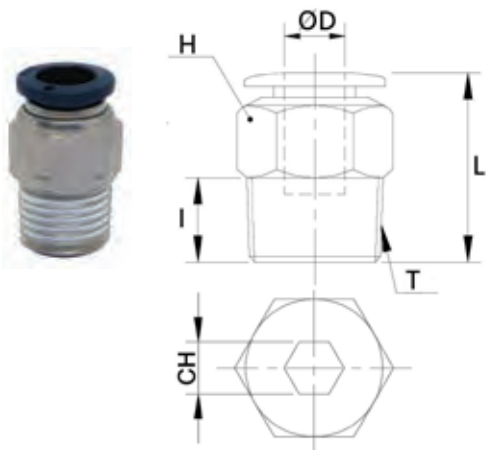

CODE	ØD	T	I	L	CH	H	GR.
WTRC04R01	4	R1/8"	7,0	19,3	3,0	10	6,2
WTRC04R02	4	R1/4"	9,5	17,9	3,0	14	9,8
WTRC06R01	6	R1/8"	7,0	20,4	4,0	12	6,9
WTRC06R02	6	R1/4"	9,5	22,7	4,0	14	13,3
WTRC06R03	6	R3/8"	10,5	20,7	4,0	17	19,9
WTRC06R04	6	R1/2"	13,5	24,7	4,0	21	39,8
WTRC08R01	8	R1/8"	7,0	25,4	5,0	14	10,0
WTRC08R02	8	R1/4"	9,5	24,9	6,0	14	11,9
WTRC08R03	8	R3/8"	10,5	21,9	6,0	17	17,5
WTRC08R04	8	R1/2"	13,5	25,9	6,0	21	37,6
WTRC10R01	10	R1/8"	7,0	27,7	5,0	17	16,4
WTRC10R02	10	R1/4"	9,5	29,5	6,0	17	18,6
WTRC10R03	10	R3/8"	10,5	27,0	8,0	17	20,7
WTRC10R04	10	R1/2"	13,5	25,3	8,0	21	34,6
WTRC12R02	12	R1/4"	9,5	32,9	6,0	20	24,5
WTRC12R03	12	R3/8"	10,5	29,9	8,0	20	25,3
WTRC12R04	12	R1/2"	13,5	32,9	8,0	21	41,0
WTRC16R03	16	R3/8"	10,5	37,6	8,0	24	42,0
WTRC16R04	16	R1/2"	13,5	35,6	10,0	24	42,1

**WTRC-G**

Male connector with internal hexagon BSPP & metric thread nickel plated

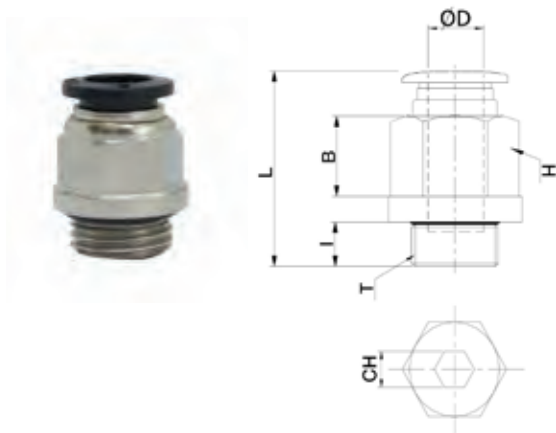

CODE	ØD	T	I	L	B	CH	H	GR.
WTRC04M5	4	M5X0,8	3,8	20,1	10,5	2,0	10	5,7
WTRC04M6	4	M6X1	4,5	20,8	10,5	2,5	10	6,1
WTRC04M7	4	M7X1	4,5	20,8	10,5	3,0	10	6,9
WTRC04G01	4	G1/8"	5,0	19,3	7,4	3,0	10	7,4
WTRC04G02	4	G1/4"	5,8	16,6	3,9	3,0	10	9,4
WTRC06M5	6	M5X0,8	3,8	21,2	10,5	2,0	12	7,4
WTRC06M6	6	M6X1	4,5	21,7	10,5	2,5	12	7,0
WTRC06M7	6	M7X1	4,5	21,9	10,5	3,0	12	7,2
WTRC06G01	6	G1/8"	5,0	19,9	6,7	4,0	12	7,5
WTRC06G02	6	G1/4"	5,8	20,4	6,4	4,0	12	10,8
WTRC06G03	6	G3/8"	6,8	20,0	4,5	4,0	12	17,0
WTRC06G04	6	G1/2"	8,0	21,7	4,5	4,0	12	27,5
WTRC08G01	8	G1/8"	5,0	24,4	11,1	5,0	14	11,7
WTRC08G02	8	G1/4"	5,8	22,2	7,0	6,0	14	11,1
WTRC08G03	8	G3/8"	6,8	21,2	4,5	6,0	14	15,7
WTRC08G04	8	G1/2"	8,0	22,9	4,5	6,0	14	27,0
WTRC10G01	10	G1/8"	5,0	26,3	11,0	5,0	17	15,9
WTRC10G02	10	G1/4"	5,8	27,5	13,9	6,0	17	20,4
WTRC10G03	10	G3/8"	6,8	25,0	8,9	8,0	17	20,6
WTRC10G04	10	G1/2"	8,0	22,7	4,9	8,0	17	28,5
WTRC12G02	12	G1/4"	5,8	31,2	12,0	6,0	20	26,3
WTRC12G03	12	G3/8"	6,8	28,2	11,0	8,0	20	24,3
WTRC12G04	12	G1/2"	8,0	28,9	9,5	8,0	20	33,3
WTRC14G03	14	G3/8"	6,8	31,8	13,0	8,0	21	30,0
WTRC14G04	14	G1/2"	8,0	29,5	10,0	10,0	24	20,0
WTRC16G03	16	G3/8"	6,8	34,9	14,5	8,0	24	42,0
WTRC16G04	16	G1/2"	8,0	36,1	18,0	10,0	24	50,7



**WTRC-N**

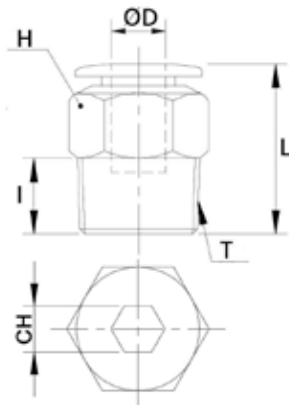

Male connector with internal hexagon NPT & UNF thread nickel plated

CODE	ØD	T	I	L	CH	H	LB
WTRC532UF1032	5/32	UNF 10-32	0,149	0,799	0,093	0,437	0,012
WTRC532N01	5/32	N1/8"	0,295	0,779	0,093	0,437	0,013
WTRC532N02	5/32	N1/4"	0,413	0,744	0,093	0,562	0,021
WTRC316UF1032	3/16	UNF 10-32	0,149	0,822	0,093	0,437	0,014
WTRC316N01	3/16	N1/8"	0,295	0,811	0,156	0,437	0,027
WTRC316N02	3/16	N1/4"	0,413	0,933	0,156	0,562	0,041
WTRC316N03	3/16	N3/8"	0,433	0,834	0,156	0,578	0,083
WTRC1-4UF1032	1/4	UNF 10-32	0,149	0,834	0,093	0,5	0,015
WTRC1-4N01	1/4	N1/8"	0,295	0,822	0,156	0,5	0,029
WTRC1-4N02	1/4	N1/4"	0,413	0,933	0,156	0,562	0,043
WTRC1-4N03	1/4	N3/8"	0,433	0,834	0,156	0,685	0,087
WTRC516N01	5/16	N1/8"	0,295	1,019	0,187	0,562	0,022
WTRC516N02	5/16	N1/4"	0,143	1,019	0,218	0,562	0,026
WTRC516N03	5/16	N3/8"	0,433	0,881	0,218	0,685	0,038
WTRC38N01	3/8	N1/8"	0,295	1,110	0,187	0,685	0,036
WTRC38N02	3/8	N1/4"	0,413	1,200	0,218	0,685	0,041
WTRC38N03	3/8	N3/8"	0,433	1,011	0,312	0,685	0,045
WTRC38N04	3/8	N1/2"	0,551	1,015	0,312	0,874	0,076
WTRC1-2N02	1/2	N1/4"	0,413	1,334	0,250	0,874	0,054
WTRC1-2N03	1/2	N3/8"	0,433	1,196	0,312	0,874	0,055
WTRC1-2N04	1/2	N1/2"	0,551	1,314	0,312	0,874	0,090

**WTROC-R**

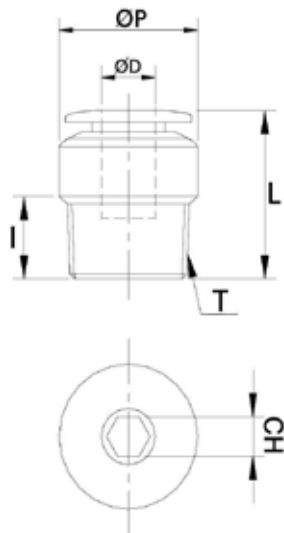

Male connector with internal hexagon BSPT thread nickel plated

CODE	ØD	T	I	L	ØP	CH	H	GR.
WTROC04R01	4	R1/8"	7,0	19,3	10	3,0	3,0	5,6
WTROC04R02	4	R1/4"	9,5	17,9	14	3,0	3,0	11,2
WTROC06R01	6	R1/8"	7,0	20,4	12	4,0	4,0	6,3
WTROC06R02	6	R1/4"	9,5	22,7	14	4,0	4,0	12,5
WTROC06R03	6	R3/8"	10,5	20,7	17	4,0	4,0	19,0
WTROC08R01	8	R1/8"	7,0	25,4	14	5,0	5,0	10,2
WTROC08R02	8	R1/4"	9,5	24,9	14	6,0	6,0	13,1
WTROC08R03	8	R3/8"	10,5	21,9	17	6,0	6,0	17,3
WTROC08R04	8	R1/2"	13,5	25,9	21	6,0	6,0	37,9
WTROC10R01	10	R1/8"	7,0	27,7	17	5,0	5,0	20,8
WTROC10R02	10	R1/4"	9,5	29,5	17	6,0	6,0	22,5
WTROC10R03	10	R3/8"	10,5	27,0	17	8,0	8,0	22,6
WTROC10R04	10	R1/2"	13,5	25,3	21	8,0	8,0	34,0
WTROC12R02	12	R1/4"	9,5	32,9	20	6,0	6,0	21,5
WTROC12R03	12	R3/8"	10,5	29,9	20	8,0	8,0	22,2
WTROC12R04	12	R1/2"	13,5	32,9	21	8,0	8,0	37,3



### WTROC-G

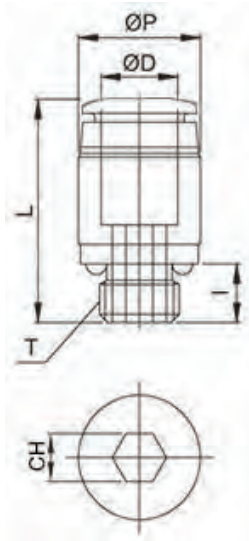

Male connector with internal hexagon metric thread nickel plated

CODE	ØD	T	I	L	ØP	CH	GR.
WTROC04M5	4	M5X0,8	3,8	20,1	10	2,0	5,2
WTROC04M6	4	M6X1	4,5	20,8	10	2,0	5,6
WTROC06M5	6	M5X0,8	3,8	21,0	12	2,0	6,8
WTROC06M6	6	M6X1	4,5	21,7	12	2,0	7,2

### WTROC-N

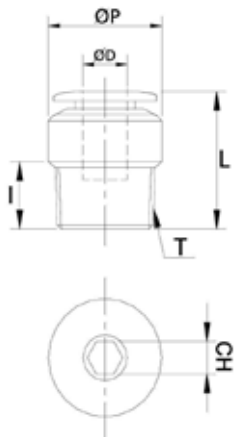

Male connector with internal hexagon NPT & UNF thread nickel plated

CODE	ØD	T	I	L	CH	H	LB
WTROC532UF1032	5/32	UNF 10-32	0,149	0,799	0,093	0,393	0,011
WTROC532N01	5/32	N1/8"	0,295	0,779	0,093	0,393	0,012
WTROC1-4UF1032	1/4	UNF 10-32	0,149	0,834	0,093	0,472	0,013
WTROC1-4N01	1/4	N1/8"	0,295	0,822	0,156	0,472	0,014
WTROC1-4N02	1/4	N1/4"	0,413	0,933	0,156	0,551	0,027
WTROC516N01	5/16	N1/8"	0,295	1,019	0,187	0,551	0,022
WTROC516N02	5/16	N1/4"	0,413	1,019	0,218	0,551	0,028
WTROC516N03	5/16	N3/8"	0,433	0,881	0,218	0,669	0,038
WTROC38N02	3/8	N1/4"	0,413	1,200	0,218	0,669	0,049
WTROC38N03	3/8	N3/8"	0,433	1,011	0,312	0,669	0,049
WTROC38N04	3/8	N1/2"	0,551	1,015	0,312	0,826	0,074
WTROC1-2N02	1/2	N1/4"	0,413	1,334	0,250	0,826	0,047
WTROC1-2N03	1/2	N3/8"	0,433	1,196	0,312	0,826	0,048
WTROC1-2N04	1/2	N1/2"	0,551	1,314	0,313	0,826	0,082





### WTRCF-G

Female connector BSPP thread nickel plated



CODE	ØD	T	I	L	H	GR.
WTRCF04G01	4	G1/8"	7,0	22,3	14	12,5
WTRCF04G02	4	G1/4"	9,0	25,3	17	18,0
WTRCF06G01	6	G1/8"	7,0	24,4	14	15,0
WTRCF06G02	6	G1/4"	9,0	26,4	17	19,3
WTRCF06G03	6	G3/8"	10,0	27,4	19	26,3
WTRCF08G01	8	G1/8"	7,0	25,9	14	15,8
WTRCF08G02	8	G1/4"	9,0	27,9	17	19,4
WTRCF08G03	8	G3/8"	10,0	28,9	19	18,4
WTRCF08G04	8	G1/2"	12,0	30,9	24	32,8
WTRCF10G01	10	G1/8"	7,0	27,7	17	28,5
WTRCF10G02	10	G1/4"	9,0	29,7	17	27,0
WTRCF10G03	10	G3/8"	10,0	30,7	19	24,6
WTRCF10G04	10	G1/2"	12,0	32,7	24	38,5
WTRCF12G02	12	G1/4"	9,0	32,9	20	44,2
WTRCF12G03	12	G3/8"	10,0	33,9	20	35,9
WTRCF12G04	12	G1/2"	12,0	35,9	24	34,2

### WTRCF-N

Female connector NPT thread nickel plated

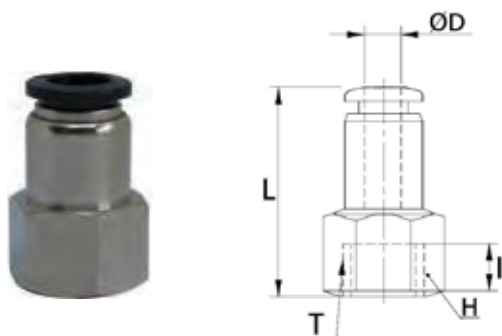

CODE	ØD	T	I	L	H	LB
WTRCF532N01	5/32	N1/8"	0,295	0,937	0,562	0,027
WTRCF532N02	5/32	N1/4"	0,413	1,055	0,685	0,039
WTRCF316N01	3/16	N1/8"	0,295	0,960	0,562	0,031
WTRCF316N02	3/16	N1/4"	0,413	1,078	0,685	0,040
WTRCF1-4N01	1/4	N1/8"	0,295	0,980	0,562	0,033
WTRCF1-4N02	1/4	N1/4"	0,413	1,098	0,685	0,042
WTRCF516N01	5/16	N1/8"	0,295	1,039	0,562	0,034
WTRCF516N02	5/16	N1/4"	0,413	1,157	0,685	0,042
WTRCF516N03	5/16	N3/8"	0,433	1,177	0,874	0,040
WTRCF38N02	3/8	N1/4"	0,413	1,228	0,685	0,059
WTRCF38N03	3/8	N3/8"	0,433	1,248	0,874	0,054
WTRCF1-2N02	1/2	N1/4"	0,413	1,354	0,874	0,097
WTRCF1-2N03	1/2	N3/8"	0,433	1,374	0,874	0,079



**WTRMF-G**

Bulkhead female connector BSPP thread nickel plated

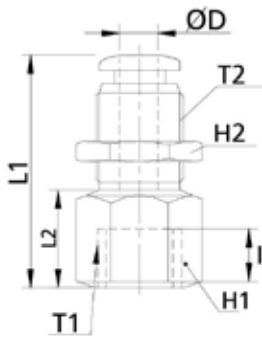

CODE	ØD	T1	T2	I	H1	H2	L1	L2	GR.
WTRMF04G01	4	G1/8"	M12X1	7,0	14	14	23,3	9,5	15,5
WTRMF04G02	4	G1/4"	M12X1	9,0	17	14	25,4	11,6	20,4
WTRMF06G01	6	G1/8"	M14X1	7,0	17	17	24,2	7,0	26,3
WTRMF06G02	6	G1/4"	M14X1	9,0	17	17	29,2	12,0	26,5
WTRMF06G03	6	G3/8"	M14X1	10,0	19	17	30,2	13,0	35,1
WTRMF08G01	8	G1/8"	M16X1	7,0	19	19	27,4	5,0	32,0
WTRMF08G02	8	G1/4"	M16X1	9,0	19	19	34,4	12,0	42,4
WTRMF08G03	8	G3/8"	M16X1	10,0	19	19	34,4	13,0	42,4
WTRMF08G04	8	G1/2"	M16X1	12,0	24	19	36,4	15,0	47,7
WTRMF10G01	10	G1/8"	M20X1	7,0	21	24	28,4	7,7	52,8
WTRMF10G02	10	G1/4"	M20X1	9,0	21	24	30,4	9,7	53,5
WTRMF10G03	10	G3/8"	M20X1	10,0	21	24	33,7	13,0	53,8
WTRMF10G04	10	G1/2"	M20X1	12,0	24	24	35,7	15,0	58,8
WTRMF12G02	12	G1/4"	M22X1	9,0	24	27	33,5	9,1	68,2
WTRMF12G03	12	G3/8"	M22X1	10,0	24	27	34,4	10,0	62,7
WTRMF12G04	12	G1/2"	M22X1	12,0	24	27	39,4	15,0	62,3

**WTRMF-N**

Bulkhead female connector NPT thread nickel plated

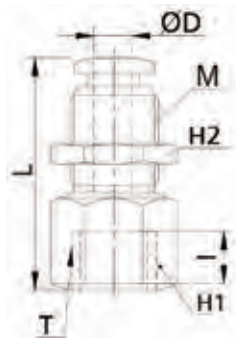

CODE	ØD	T	M	I	H1	H2	L	LB
WTRMF532N01	5/32	N1/8"	M12X1	0,295	0,562	0,562	0,937	0,034
WTRMF316N02	3/16	N1/4"	M14X1	0,413	0,685	0,685	1,196	0,055
WTRMF1-4N01	1/4	N1/8"	M14X1	0,295	0,685	0,685	0,972	0,057
WTRMF1-4N02	1/4	N1/4"	M14X1	0,413	0,685	0,685	1,196	0,058
WTRMF516N01	5/16	N1/8"	M16X1	0,295	0,685	0,748	1,098	0,070
WTRMF516N02	5/16	N1/4"	M16X1	0,413	0,748	0,748	1,413	0,093
WTRMF516N03	5/16	N3/8"	M16X1	0,433	0,748	0,748	1,393	0,093
WTRMF38N02	3/8	N1/4"	M20X1	0,413	0,874	0,874	1,255	0,117
WTRMF38N03	3/8	N3/8"	M20X1	0,0433	0,874	0,874	1,366	0,118
WTRMF1-2N03	1/2	N3/8"	M22X1	0,433	1	1	1,393	0,138
WTRMF1-2N04	1/2	N1/2"	M22X1	0,551	1	1	1,629	0,137



**WTRMM**

Bulkhead connector nickel plated

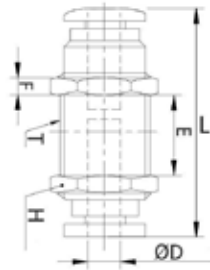

CODE	ØD	T	E	L	F	H	GR.
WTRMM0400	4	M12X1	9,7	30,1	3,5	14	15,4
WTRMM0600	6	M14X1	7,5	31,8	4,0	17	21,4
WTRMM0800	8	M16X1	6,8	35,3	4,5	19	26,8
WTRMM1000	10	M20X1	11,5	39,0	5,0	24	52,7
WTRMM1200	12	M22X1	12,8	45,3	5,0	27	59,8

**WTRMM-N**

Bulkhead connector nickel plated

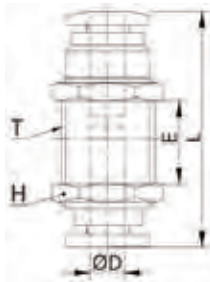

CODE	ØD	T	E	L	H	LB
WTRMM532	5/32	M12X1	0,381	1,185	0,562	0,034
WTRMM316	3/16	M14X1	0,295	1,251	0,685	0,045
WTRMM1-4	1/4	M14X1	0,295	1,251	0,685	0,047
WTRMM516	5/16	M16X1	0,267	1,389	0,748	0,059
WTRMM38	3/8	M20X1	0,350	1,433	0,874	0,116
WTRMM1-2	1/2	M22X1	0,503	1,783	1	0,131

**WTRSL-R**

Short swivel male elbow BSPT thread nickel plated

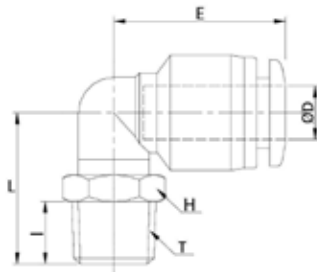

CODE	ØD	T	I	L	E	H	GR.
WTRSL04R01	4	R1/8"	7,0	16,0	17,5	10,0	5,8
WTRSL04R02	4	R1/4"	9,5	19,5	17,5	14,0	6,3
WTRSL06R01	6	R1/8"	7,0	17,0	19,0	10,0	6,4
WTRSL06R02	6	R1/4"	9,5	20,5	19,0	14,0	12,4
WTRSL06R03	6	R3/8"	10,5	22,0	19,0	17,0	14,2
WTRSL06R04	6	R1/2"	13,5	25,5	19,0	21,0	17,3
WTRSL08R01	8	R1/8"	7,0	21,3	22,8	12,0	11,5
WTRSL08R02	8	R1/4"	9,5	21,5	22,8	14,0	13,3
WTRSL08R03	8	R3/8"	10,5	23,0	22,8	17,0	20,3
WTRSL08R04	8	R1/2"	13,5	26,5	22,8	21,0	21,9
WTRSL10R01	10	R1/8"	7,0	25,5	26,3	14,0	15,4
WTRSL10R02	10	R1/4"	9,5	26,0	26,3	14,0	18,4
WTRSL10R03	10	R3/8"	10,5	25,0	26,3	17,0	21,9
WTRSL10R04	10	R1/2"	13,5	28,5	26,3	21,0	24,8
WTRSL12R02	12	R1/4"	9,5	29,5	29,6	17,0	33,6
WTRSL12R03	12	R3/8"	10,5	26,5	29,6	17,0	36,2
WTRSL12R04	12	R1/2"	13,5	30,0	29,6	21,0	39,5



**WTRSL-G**

Short swivel male elbow BSPP & metric thread nickel plated

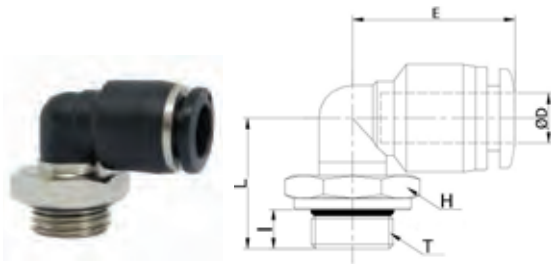

CODE	ØD	T	I	L	E	H	GR.
WTRSL04M5	4	M5X0,8	3,8	15,3	17,5	8,0	5,2
WTRSL04M7	4	M7X1	4,5	17,0	17,5	10,0	6,1
WTRSL04G01	4	G1/8"	4,8	14,8	17,5	14,0	7,6
WTRSL04G02	4	G1/4"	5,5	16,0	17,5	17,0	11,3
WTRSL06M5	6	M5X0,8	3,8	15,3	19,0	8,0	5,8
WTRSL06M7	7	M7X1	4,5	17,0	19,0	10	6,7
WTRSL06G01	6	G1/8"	4,8	15,8	19,0	14,0	8,3
WTRSL06G02	6	G1/4"	5,5	17,0	19,0	17,0	13,3
WTRSL06G03	6	G3/8"	6,5	18,5	19,0	20,0	16,8
WTRSL06G04	6	G1/2"	7,5	19,5	19,0	24,0	20,1
WTRSL08G01	8	G1/8"	4,8	20,0	22,8	14,0	11,9
WTRSL08G02	8	G1/4"	5,5	18,0	22,8	17,0	13,8
WTRSL08G03	8	G3/8"	6,5	19,5	22,8	20,0	21,2
WTRSL08G04	8	G1/2"	7,5	20,5	22,8	24,0	23,9
WTRSL10G01	10	G1/8"	4,8	24,3	26,3	14,0	21,3
WTRSL10G02	10	G1/4"	5,5	23,1	26,3	17,0	24,3
WTRSL10G03	10	G3/8"	6,5	21,5	26,3	20,0	27,6
WTRSL10G04	10	G1/2"	7,5	22,5	26,3	24,0	31,2
WTRSL12G02	12	G1/4"	5,5	26,5	29,6	17,0	33,8
WTRSL12G03	12	G3/8"	6,5	23,0	29,6	20,0	35,6
WTRSL12G04	12	G1/2"	7,5	24,0	29,6	24,0	39,8

**WTRL-R**

Swivel male elbow BSPT thread nickel plated

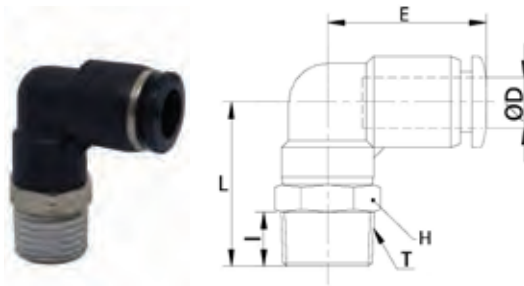

CODE	ØD	T	I	L	E	H	GR.
WTRL04R01	4	R1/8"	7,0	23,5	17,5	10	8,1
WTRL04R02	4	R1/4"	9,5	27,0	17,5	14	13,9
WTRL06R01	6	R1/8"	7,0	25,2	19,0	12	11,5
WTRL06R02	6	R1/4"	9,5	28,2	19,0	14	16,5
WTRL06R03	6	R3/8"	10,5	29,7	19,0	17	22,6
WTRL06R04	6	R1/2"	13,5	33,2	19,0	21	35,9
WTRL08R01	8	R1/8"	7,0	26,5	22,8	14	17,6
WTRL08R02	8	R1/4"	9,5	29,0	22,8	14	17,7
WTRL08R03	8	R3/8"	10,5	30,5	22,8	17	25,3
WTRL08R04	8	R1/2"	13,5	34,0	22,8	21	38,2
WTRL10R01	10	R1/8"	7,0	29,5	26,3	17	30,7
WTRL10R02	10	R1/4"	9,5	32,0	26,3	17	31,4
WTRL10R03	10	R3/8"	10,5	33,0	26,3	17	30,8
WTRL10R04	10	R1/2"	13,5	36,5	26,3	21	47,3
WTRL12R02	12	R1/4"	9,5	35,5	29,6	20	44,3
WTRL12R03	12	R3/8"	10,5	36,5	29,6	20	46,7
WTRL12R04	12	R1/2"	13,5	39,5	29,6	21	51,2
WTRL14R03	14	R3/8"	10,5	41,5	31,7	24	53,0
WTRL14R04	14	R1/2"	13,5	45,5	31,7	24	62,0
WTRL16R03	16	R3/8"	10,5	43,0	33,0	24	67,6
WTRL16R04	16	R1/2"	13,5	46,0	33,0	24	72,8



## WTRL-G

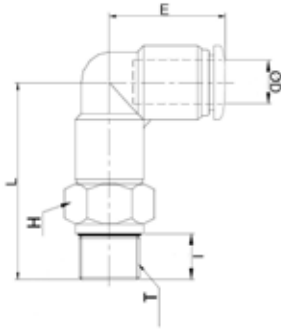

Swivel male elbow BSPP &amp; metric thread nickel plated

CODE	ØD	T	I	L	E	H	GR.
WTRL04M5	4	M5X0,8	3,8	17,3	17,5	8	5,1
WTRL04M6	4	M6X1	4,5	18,0	17,5	8	5,3
WTRL04G01	4	G1/8"	5,0	24,0	17,5	14	11,8
WTRL04G02	4	G1/4"	5,8	25,3	17,5	17	17,9
WTRL06M5	6	M5X0,8	3,8	17,3	19,0	8	5,8
WTRL06M6	6	M6X1	4,5	18,0	19,0	8	6,0
WTRL06G01	6	G1/8"	5,0	25,2	19,0	14	14,6
WTRL06G02	6	G1/4"	5,8	26,5	19,0	17	17,5
WTRL06G03	6	G3/8"	6,8	28,0	19,0	20	24,4
WTRL06G04	6	G1/2"	8,0	29,2	19,0	24	38,4
WTRL08G01	8	G1/8"	5,0	26,0	22,8	14	17,5
WTRL08G02	8	G1/4"	5,8	27,3	22,8	17	20,5
WTRL08G03	8	G3/8"	6,8	28,8	22,8	20	26,6
WTRL08G04	8	G1/2"	8,0	30,0	22,8	24	36,8
WTRL10G01	10	G1/8"	5,0	29,0	26,3	17	31,2
WTRL10G02	10	G1/4"	5,8	29,8	26,3	17	30,5
WTRL10G03	10	G3/8"	6,8	31,3	26,3	20	34,6
WTRL10G04	10	G1/2"	8,0	33,5	26,3	24	47,3
WTRL12G02	12	G1/4"	5,8	33,8	29,6	20	43,9
WTRL12G03	12	G3/8"	6,8	34,8	29,6	20	44,5
WTRL12G04	12	G1/2"	8,0	36,5	29,6	24	51,8
WTRL14G03	14	G3/8"	6,8	39,8	31,7	24	52,0
WTRL14G04	14	G1/2"	8,0	41,5	31,7	24	61,0
WTRL16G03	16	G3/8"	6,8	40,8	33,0	24	64,0
WTRL16G04	16	G1/2"	8,0	42,0	33,0	24	66,5



**WTRL-N**

Swivel male elbow NPT & UNF thread nickel plated

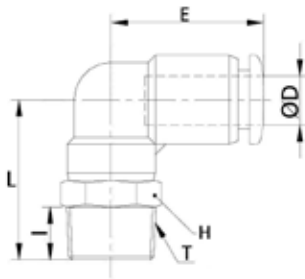

CODE	ØD	T	I	L	E	H	LB
WTRL532UF1032	5/32	UNF 10-32	0,149	0,681	0,688	0,314	0,016
WTRL532N01	5/32	N1/8"	0,295	0,944	0,688	0,437	0,017
WTRL532N02	5/32	N1/4"	0,413	1,102	0,688	0,562	0,030
WTRL316UF1032	3/16	UNF 10-32	0,149	0,866	0,700	0,437	0,016
WTRL316N01	3/16	N1/8"	0,295	0,964	0,700	0,437	0,025
WTRL316N02	3/16	N1/4"	0,413	1,102	0,700	0,562	0,034
WTRL316N03	3/16	N3/8"	0,433	1,141	0,700	0,685	0,047
WTRL1-4UF1032	1/4	UNF 10-32	0,149	0,681	0,748	0,314	0,024
WTRL1-4N01	1/4	N1/8"	0,295	1,011	0,748	0,5	0,025
WTRL1-4N02	1/4	N1/4"	0,413	1,149	0,748	0,562	0,036
WTRL1-4N03	1/4	N3/8"	0,433	1,188	0,748	0,685	0,049
WTRL516N01	5/16	N1/8"	0,295	1,062	0,897	0,562	0,038
WTRL516N02	5/16	N1/4"	0,413	1,181	0,897	0,562	0,039
WTRL516N03	5/16	N3/8"	0,433	1,220	0,897	0,685	0,055
WTRL38N01	3/8	N1/8"	0,295	1,181	1,035	0,685	0,067
WTRL38N02	3/8	N1/4"	0,413	1,299	1,035	0,685	0,069
WTRL38N03	3/8	N3/8"	0,433	1,318	1,035	0,685	0,067
WTRL38N04	3/8	N1/2"	0,551	1,456	1,035	0,874	0,104
WTRL1-2N02	1/2	N1/4"	0,413	1,437	1,165	0,874	0,097
WTRL1-2N03	1/2	N3/8"	0,433	1,456	1,165	0,874	0,102
WTRL1-2N04	1/2	N1/2"	0,551	1,574	1,165	0,874	0,112

**WTRLL-R**

Long swivel male elbow BSPT thread nickel plated

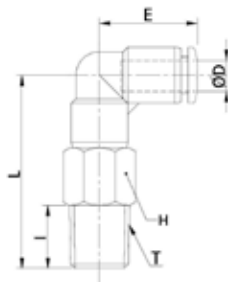

CODE	ØD	T	I	L	E	H	GR.
WTRLL04R01	4	R1/8"	7,0	35,5	17,5	10,0	14,2
WTRLL04R02	4	R1/4"	9,5	39,0	17,5	14,0	26,2
WTRLL06R01	6	R1/8"	7,0	39,2	19,0	12,0	22,0
WTRLL06R02	6	R1/4"	9,5	42,2	19,0	14,0	29,2
WTRLL06R03	6	R3/8"	10,5	43,7	19,0	17,0	39,4
WTRLL06R04	6	R1/2"	13,5	47,2	19,0	21,0	62,9
WTRLL08R01	8	R1/8"	7,0	41,8	22,8	14,0	34,6
WTRLL08R02	8	R1/4"	9,5	44,3	22,8	14,0	33,1
WTRLL08R03	8	R3/8"	10,5	45,8	22,8	17,0	45,6
WTRLL08R04	8	R1/2"	13,5	49,3	22,8	21,0	70,1
WTRLL10R01	10	R1/8"	7,0	49,5	26,3	17,0	61,2
WTRLL10R02	10	R1/4"	9,5	52,0	26,3	17,0	62,5
WTRLL10R03	10	R3/8"	10,5	53,0	26,3	17,0	56,7
WTRLL10R04	10	R1/2"	13,5	56,5	26,3	21,0	87,2
WTRLL12R02	12	R1/4"	9,5	58,5	29,6	20,0	86,7
WTRLL12R03	12	R3/8"	10,5	59,5	29,6	20,0	100,7
WTRLL12R04	12	R1/2"	13,5	62,5	29,6	21,0	89,7



## WTRLL-G

Long swivel male elbow BSPP & metric thread nickel plated

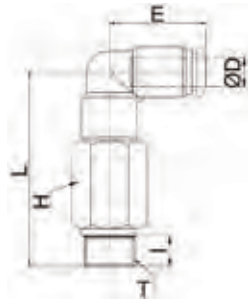

CODE	ØD	T	I	L	E	H	GR.
WTRLL04M5	4	M5X0,8	3,8	29,3	17,5	8,0	10,4
WTRLL04M6	4	M6X1	4,5	30,0	17,5	8,0	10,8
WTRLL04G01	4	G1/8"	5,0	36,0	17,5	14,0	25,9
WTRLL04G02	4	G1/4"	5,8	37,3	17,5	17,0	26,6
WTRLL06M5	6	M5X0,8	3,8	31,3	19,0	8,0	11,4
WTRLL06M6	6	M6X1	4,5	32,0	19,0	8,0	11,8
WTRLL06G01	6	G1/8"	5,0	39,2	19,0	14,0	30,5
WTRLL06G02	6	G1/4"	5,8	40,5	19,0	17,0	43,3
WTRLL06G03	6	G3/8"	6,8	42,0	19,0	20,0	57,0
WTRLL06G04	6	G1/2"	8,0	43,2	19,0	24,0	91,5
WTRLL08G01	8	G1/8"	5,0	41,3	22,8	14,0	35,4
WTRLL08G02	8	G1/4"	5,8	42,6	22,8	17,0	48,0
WTRLL08G03	8	G3/8"	6,8	44,1	22,8	20,0	60,3
WTRLL08G04	8	G1/2"	8,0	45,3	22,8	24,0	93,7
WTRLL10G01	10	G1/8"	5,0	49,0	26,3	17,0	61,8
WTRLL10G02	10	G1/4"	5,8	49,8	26,3	17,0	68,7
WTRLL10G03	10	G3/8"	6,8	51,3	26,3	20,0	78,7
WTRLL10G04	10	G1/2"	8,0	53,5	26,3	24,0	105,8
WTRLL12G02	12	G1/4"	5,8	56,8	29,6	20,0	98,1
WTRLL12G03	12	G3/8"	6,8	57,8	29,6	20,0	101,9
WTRLL12G04	12	G1/2"	8,0	59,5	29,6	24,0	124,3

## WTRLL-N

Long swivel male elbow NPT & UNF thread nickel plated

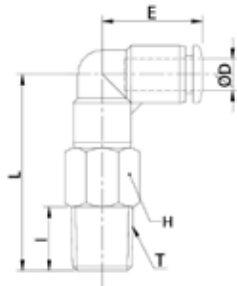

CODE	ØD	T	A	B	E	H	LB
WTRLL532UF1032	5/32	UNF 10-32	0,149	1,318	0,688	0,437	0,029
WTRLL532N01	5/32	N1/8"	0,295	1,417	0,688	0,437	0,031
WTRLL316N01	3/16	N1/8"	0,295	1,417	0,700	0,437	0,046
WTRLL316N02	3/16	N1/4"	0,413	1,555	0,700	0,562	0,061
WTRLL316N03	3/16	N3/8"	0,433	1,594	0,700	0,685	0,082
WTRLL1-4N01	1/4	N1/8"	0,295	1,562	0,748	0,5	0,048
WTRLL1-4N02	1/4	N1/4"	0,413	1,700	0,748	0,562	0,064
WTRLL1-4N03	1/4	N3/8"	0,433	1,740	0,748	0,685	0,086
WTRLL516N01	5/16	N1/8"	0,295	1,665	0,897	0,562	0,076
WTRLL516N02	5/16	N1/4"	0,413	1,783	0,897	0,562	0,073
WTRLL516N03	5/16	N3/8"	0,433	1,822	0,897	0,685	0,100
WTRLL38N02	3/8	N1/4"	0,413	2,047	1,035	0,685	0,137
WTRLL38N03	3/8	N3/8"	0,433	2,106	1,035	0,685	0,125
WTRLL38N04	3/8	N1/2"	0,551	2,244	1,035	0,874	0,192
WTRLL1-2N02	1/2	N1/4"	0,413	2,342	1,165	0,874	0,191
WTRLL1-2N03	1/2	N3/8"	0,433	2,362	1,165	0,874	0,222
WTRLL1-2N04	1/2	N1/2"	0,551	2,480	1,165	0,874	0,197



**WTRLH-R**

Swivel male elbow 45° BSPT thread nickel plated

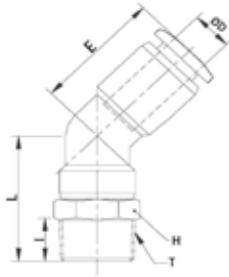

CODE	ØD	T	I	L	E	H	GR.
WTRLH04R01	4	R1/8"	7,0	22,2	16,2	10	8,0
WTRLH04R02	4	R1/4"	9,5	25,7	16,2	14	13,8
WTRLH06R01	6	R1/8"	7,0	23,9	17,7	12	11,0
WTRLH06R02	6	R1/4"	9,5	26,9	17,7	14	16,0
WTRLH06R03	6	R3/8"	10,5	28,4	17,7	17	22,2
WTRLH06R04	6	R1/2"	13,5	31,9	17,7	21	35,4
WTRLH08R01	8	R1/8"	7,0	27,1	20,9	14	17,3
WTRLH08R02	8	R1/4"	9,5	29,6	20,9	14	17,4
WTRLH08R03	8	R3/8"	10,5	31,1	20,9	17	25,0
WTRLH08R04	8	R1/2"	13,5	34,6	20,9	21	37,9
WTRLH10R01	10	R1/8"	7,0	29,7	22,2	17	30,0
WTRLH10R02	10	R1/4"	9,5	32,2	22,2	17	30,7
WTRLH10R03	10	R3/8"	10,5	33,2	22,2	17	30,1
WTRLH10R04	10	R1/2"	13,5	36,7	22,2	21	46,6
WTRLH12R02	12	R1/4"	9,5	35,2	26,3	21	42,6
WTRLH12R03	12	R3/8"	10,5	36,2	26,3	21	45,0
WTRLH12R04	12	R1/2"	13,5	39,2	26,3	21	49,5

**WTRLH-G**

Swivel male elbow 45° BSPP & metric thread nickel plated

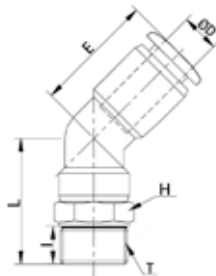

CODE	ØD	T	I	L	E	H	GR.
WTRLH04M5	4	M5X0,8	3,8	20,0	16,2	10	8,1
WTRLH04M6	4	M6X1	4,5	20,7	16,2	10	8,3
WTRLH04G01	4	G1/8"	5,0	22,7	16,2	14	11,7
WTRLH04G02	4	G1/4"	5,8	24,0	16,2	17	17,8
WTRLH06M5	6	M5X0,8	3,8	21,7	17,7	12	10,8
WTRLH06M6	6	M6X1	4,5	22,4	17,7	12	11,5
WTRLH06G01	6	G1/8"	5,0	23,9	17,7	14	14,2
WTRLH06G02	6	G1/4"	5,8	25,2	17,7	17	17,5
WTRLH06G03	6	G3/8"	6,8	26,7	17,7	20	24,0
WTRLH06G04	6	G1/2"	8,0	27,9	17,7	24	38,0
WTRLH08G01	8	G1/8"	5,0	26,6	20,9	14	17,2
WTRLH08G02	8	G1/4"	5,8	27,9	20,9	17	20,2
WTRLH08G03	8	G3/8"	6,8	29,4	20,9	20	26,3
WTRLH08G04	8	G1/2"	8,0	30,6	20,9	24	36,5
WTRLH10G01	10	G1/8"	5,0	29,2	22,2	17	30,6
WTRLH10G02	10	G1/4"	5,8	30,0	22,2	17	29,9
WTRLH10G03	10	G3/8"	6,8	31,5	22,2	20	34,0
WTRLH10G04	10	G1/2"	8,0	33,7	22,2	24	46,7
WTRLH12G02	12	G1/4"	5,8	33,5	26,3	21	42,4
WTRLH12G03	12	G3/8"	6,8	34,5	26,3	21	43,0
WTRLH12G04	12	G1/2"	8,0	36,2	26,3	24	50,3





**WTRLH-N**

Swivel male elbow 45° NPT & UNF thread nickel plated

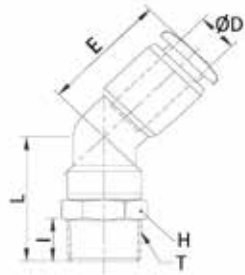

CODE	ØD	T	I	L	E	H	LB
WTRLH532UF1032	5/32	UNF 10-32	0,149	0,814	0,637	0,437	0,016
WTRLH532N01	5/32	N1/8"	0,295	0,893	0,637	0,437	0,017
WTRLH532N02	5/32	N1/4"	0,413	1,051	0,637	0,562	0,030
WTRLH316UF1032	3/16	UNF 10-32	0,149	0,814	0,649	0,437	0,023
WTRLH316N01	3/16	N1/8"	0,295	0,913	0,649	0,437	0,024
WTRLH316N02	3/16	N1/4"	0,413	1,051	0,649	0,562	0,033
WTRLH316N03	3/16	N3/8"	0,433	1,090	0,649	0,685	0,046
WTRLH1-4UF1032	1/4	UNF 10-32	0,149	0,909	0,696	0,5	0,023
WTRLH1-4N01	1/4	N1/8"	0,295	0,960	0,696	0,5	0,024
WTRLH1-4N02	1/4	N1/4"	0,413	1,097	0,696	0,562	0,035
WTRLH1-4N03	1/4	N3/8"	0,433	1,137	0,696	0,685	0,049
WTRLH516N01	5/16	N1/8"	0,295	0,295	0,822	0,562	0,038
WTRLH516N02	5/16	N1/4"	0,413	0,413	0,822	0,562	0,038
WTRLH516N03	5/16	N3/8"	0,433	0,433	0,822	0,685	0,055
WTRLH38N01	3/8	N1/8"	0,295	1,118	0,874	0,685	0,066
WTRLH38N02	3/8	N1/4"	0,413	1,307	0,874	0,685	0,067
WTRLH38N03	3/8	N3/8"	0,433	1,326	0,874	0,685	0,066
WTRLH38N04	3/8	N1/2"	0,551	1,464	0,874	0,874	0,102
WTRLH1-2N02	1/2	N1/4"	0,413	1,425	1,035	0,874	0,093
WTRLH1-2N03	1/2	N3/8"	0,433	1,444	1,035	0,874	0,99
WTRLH1-2N04	1/2	N1/2"	0,551	1,562	1,035	0,874	0,109

**WTRLF-G**

Swivel female elbow BSPP & metric thread nickel plated

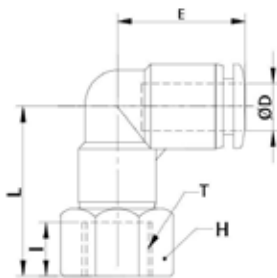

CODE	ØD	T	I	L	E	H	GR.
WTRLF04M5	4	M5X0,8	4,5	19,5	17,5	10,0	7,4
WTRLF04M6	4	M6X1	5,0	20,0	17,5	10,0	7,2
WTRLF04G01	4	G1/8"	7,0	23,0	17,5	14,0	13,9
WTRLF04G02	4	G1/4"	9,0	25,0	17,5	17,0	18,2
WTRLF06M5	6	M5X0,8	4,5	20,7	19,0	12,0	10,6
WTRLF06M6	6	M6X1	5,0	21,2	19,0	12,0	10,4
WTRLF06G01	6	G1/8"	7,0	24,4	19,0	14,0	16,4
WTRLF06G02	6	G1/4"	9,0	26,4	19,0	17,0	21,3
WTRLF06G03	6	G3/8"	10,0	27,7	19,0	19,0	30,0
WTRLF08G01	8	G1/8"	7,0	24,8	22,8	14,0	19,4
WTRLF08G02	8	G1/4"	9,0	27,0	22,8	17,0	24,1
WTRLF08G03	8	G3/8"	10,0	28,5	22,8	19,0	32,4
WTRLF08G04	8	G1/2"	12,0	30,5	22,8	24,0	41,6
WTRLF10G01	10	G1/8"	7,0	23,0	26,3	17,0	27,7
WTRLF10G02	10	G1/4"	9,0	29,5	26,3	17,0	33,8
WTRLF10G03	10	G3/8"	10,0	31,0	26,3	19,0	34,3
WTRLF10G04	10	G1/2"	12,0	33,5	26,3	24,0	51,2
WTRLF12G02	12	G1/4"	9,0	26,0	29,6	21,0	36,7
WTRLF12G03	12	G3/8"	10,0	34,0	29,6	21,0	49,2
WTRLF12G04	12	G1/2"	12,0	36,5	29,6	24,0	54,7



**WTRLF-N**

Swivel female elbow NPT thread nickel plated

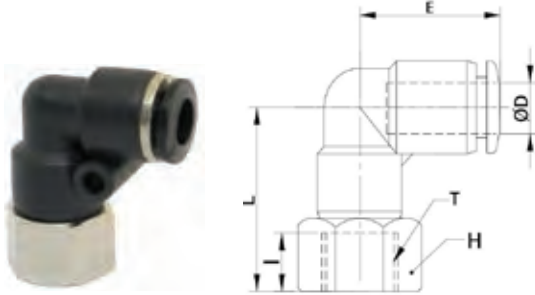

CODE	ØD	T	I	L	E	H	LB
WTRLF532N01	5/32	N1/8"	0,295	0,925	0,688	0,562	0,030
WTRLF316N01	3/16	N1/8"	0,295	0,937	0,700	0,562	0,034
WTRLF316N02	3/16	N1/4"	0,413	1,043	0,700	0,685	0,044
WTRLF1-4N01	1/4	N1/8"	0,295	0,980	0,748	0,562	0,036
WTRLF1-4N02	1/4	N1/4"	0,413	1,098	0,748	0,685	0,047
WTRLF516N01	5/16	N1/8"	0,295	0,984	0,897	0,562	0,042
WTRLF516N02	5/16	N1/4"	0,413	1,122	0,897	0,685	0,053
WTRLF516N03	5/16	N3/8"	0,433	1,161	0,897	0,874	0,071
WTRLF38N02	3/8	N1/4"	0,413	1,220	1,035	0,685	0,074
WTRLF38N03	3/8	N3/8"	0,433	1,240	1,035	0,874	0,075
WTRLF1-2N03	1/2	N3/8"	0,433	1,358	1,165	0,874	0,108
WTRLF1-2N04	1/2	N1/2"	0,551	1,476	1,165	1	0,120

**WTRLM**

Bulkhead elbow nickel plated

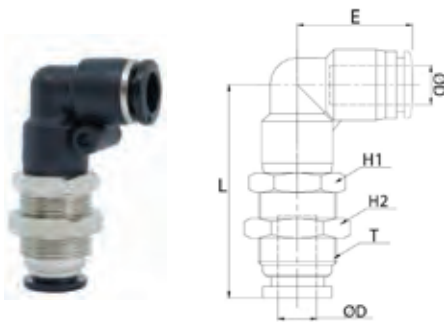

CODE	ØD	T	L	E	H1	H2	GR.
WTRLM04	4	M12X1	28,5	17,5	14	14	15,0
WTRLM06	6	M14X1	34,1	19,0	17	17	27,2
WTRLM08	8	M16X1	43,4	22,8	17	19	38,0
WTRLM10	10	M20X1	45,5	26,3	21	24	55,0
WTRLM12	12	M22X1	51,6	29,6	24	27	85,0

**WTRH-R**

Swivel male banjo elbow BSPT thread nickel plated

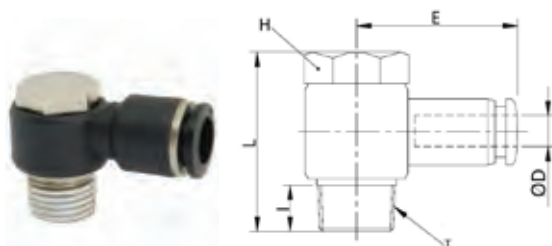

CODE	ØD	T	I	L	E	H	GR.
WTRH04R01	4	R1/8"	7,0	23,0	22,3	10	10,5
WTRH04R02	4	R1/4"	9,5	26,3	24,05	14	21,9
WTRH06R01	6	R1/8"	7,0	23,0	23,1	10	11,0
WTRH06R02	6	R1/4"	9,5	26,3	25,1	14	22,5
WTRH06R03	6	R3/8"	10,5	31,9	26,8	19	37,8
WTRH08R01	8	R1/8"	7,0	23,0	25,6	10	11,8
WTRH08R02	8	R1/4"	9,5	26,3	28,6	14	23,3
WTRH08R03	8	R3/8"	10,5	31,9	29,6	19	38,4
WTRH08R04	8	R1/2"	13,5	38,6	32,6	24	75,4
WTRH10R02	10	R1/4"	9,5	26,3	31,0	14	26,7
WTRH10R03	10	R3/8"	10,5	31,9	31,6	19	41,8
WTRH10R04	10	R1/2"	13,5	38,6	34,6	24	78,8
WTRH12R02	12	R1/4"	9,5	26,3	33,5	14	28,2
WTRH12R03	12	R3/8"	10,5	31,9	35,6	19	43,4
WTRH12R04	12	R1/2"	13,5	38,6	36,6	24	80,3



**WTRH-G**

Swivel male banjo elbow BSPP & metric thread nickel plated

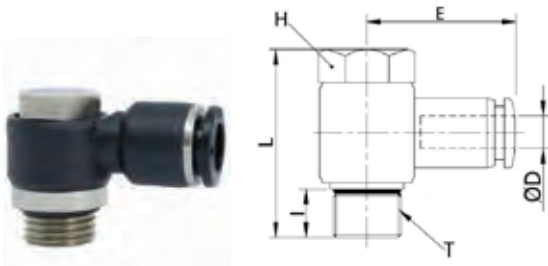

CODE	ØD	T	I	L	E	H	GR.
WTRH04M5	4	M5X0,8	4,0	18,0	20,0	8	6,6
WTRH04M6	4	M6X1	4,5	18,5	20,0	8	11,8
WTRH04G01	4	G1/8"	5,0	22,5	22,3	10	11,5
WTRH06M5	6	M5X0,8	4,0	18,0	21,9	8	7,2
WTRH06M6	6	M6X1	4,5	18,5	21,9	8	12,4
WTRH06G01	6	G1/8"	5,0	22,5	23,1	10	12,0
WTRH06G02	6	G1/4"	5,8	26,2	25,15	14	23,0
WTRH08G01	8	G1/8"	5,0	22,5	25,6	10	12,8
WTRH08G02	8	G1/4"	5,8	26,2	28,65	14	23,8
WTRH08G03	8	G3/8"	6,8	31,7	29,6	19	40,9
WTRH10G02	10	G1/4"	5,8	26,2	31,05	14	27,2
WTRH10G03	10	G3/8"	6,8	31,7	31,6	19	44,3
WTRH12G03	12	G3/8"	6,8	31,7	35,6	19	45,9
WTRH12G04	12	G1/2"	8,0	37,1	36,6	24	79,3

**WTRH-N**

Swivel male banjo elbow NPT & UNF thread nickel plated

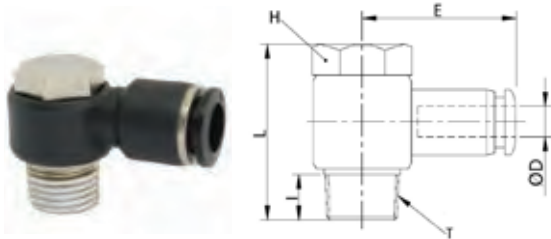

CODE	ØD	T	I	L	E	H	LB
WTRH532UF1032	5/32	UNF 10-32	0,149	0,700	0,787	0,314	0,022
WTRH532N01	5/32	N1/8"	0,295	0,925	0,877	0,437	0,023
WTRH316UF1032	3/16	UNF 10-32	0,149	0,700	0,799	0,314	0,023
WTRH316N01	3/16	N1/8"	0,295	0,925	0,889	0,437	0,024
WTRH316N02	3/16	N1/4"	0,413	1,074	0,956	0,562	0,049
WTRH1-4N01	1/4	N1/8"	0,295	0,295	0,909	0,437	0,024
WTRH1-4N02	1/4	N1/4"	0,413	1,074	0,988	0,562	0,049
WTRH516N01	5/16	N1/8"	0,295	0,925	1,007	0,437	0,026
WTRH516N02	5/16	N1/4"	0,413	1,074	1,125	0,562	0,051
WTRH516N03	5/16	N3/8"	0,433	1,275	1,165	0,748	0,084
WTRH38N02	3/8	N1/4"	0,413	1,074	1,220	0,562	0,058
WTRH38N03	3/8	N3/8"	0,433	1,275	1,244	0,748	0,092
WTRH1-2N03	1/2	N3/8"	0,433	1,275	1,401	0,748	0,095
WTRH1-2N04	1/2	N1/2"	0,551	1,539	1,440	1	0,177



**WTRHF-R**

Swivel female banjo elbow BSPT thread nickel plated

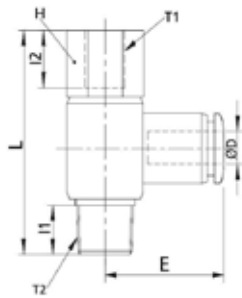

CODE	ØD	T1	T2	I1	I2	H	L	E	GR.
WTRHF04R01	4	G1/8"	R1/8"	7,0	7,0	14	29,0	22,3	16,4
WTRHF04R02	4	G1/4"	R1/4"	9,5	9,0	17	33,3	24,1	27,4
WTRHF06R01	6	G1/8"	R1/8"	7,0	7,0	14	29,0	23,1	17,0
WTRHF06R02	6	G1/4"	R1/4"	9,5	9,0	17	33,3	25,1	28,0
WTRHF06R03	6	G3/8"	R3/8"	10,5	10,0	19	39,9	26,8	44,8
WTRHF08R01	8	G1/8"	R1/8"	7,0	7,0	14	29,0	25,6	17,8
WTRHF08R02	8	G1/4"	R1/4"	9,5	9,0	17	33,3	28,6	28,8
WTRHF08R03	8	G3/8"	R3/8"	10,5	10,0	19	39,9	29,6	45,4
WTRHF08R04	8	G1/2"	R1/2"	13,5	12,0	24	46,5	32,6	71,9
WTRHF10R02	10	G1/4"	R1/4"	9,5	9,0	17	33,3	31,0	32,2
WTRHF10R03	10	G3/8"	R3/8"	10,5	10,0	19	39,9	31,6	48,8
WTRHF10R04	10	G1/2"	R1/2"	13,5	12,0	24	46,5	34,6	75,3
WTRHF12R02	12	G1/4"	R1/4"	9,5	9,0	17	33,3	33,5	33,7
WTRHF12R03	12	G3/8"	R3/8"	10,5	10,0	19	39,9	35,6	50,4
WTRHF12R04	12	G1/2"	R1/2"	13,5	12,0	24	46,5	36,6	76,8

**WTRHF-G**

Swivel female banjo elbow BSPP & metric thread nickel plated

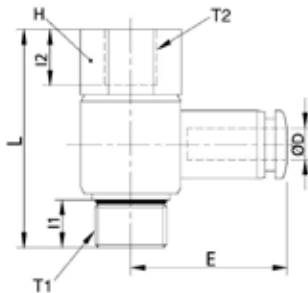

CODE	ØD	T1	T2	I1	I2	H	L	E	GR.
WTRHF04M5	4	M5X0,8	M5X0,8	4,0	5,5	10	20,5	20,0	8,3
WTRHF04M6	4	M6X1	M6X1	4,5	6,0	10	21,0	20,0	8,3
WTRHF04G01	4	G1/8"	G1/8"	5,5	7,0	14	30,0	22,3	18,4
WTRHF06M5	6	M5X0,8	M5X0,8	4,0	5,5	10	20,5	21,9	8,9
WTRHF06M6	6	M6X1	M6X1	4,5	6,0	10	21,0	21,9	8,9
WTRHF06G01	6	G1/8"	G1/8"	5,5	7,0	14	30,0	23,1	19,0
WTRHF06G02	6	G1/4"	G1/4"	6,5	9,0	17	33,7	25,1	30,5
WTRHF08G01	8	G1/8"	G1/8"	5,5	7,0	14	30,0	25,6	19,8
WTRHF08G02	8	G1/4"	G1/4"	6,5	9,0	17	33,7	28,6	31,3
WTRHF08G03	8	G3/8"	G3/8"	7,5	10,0	19	39,7	29,6	47,9
WTRHF10G02	10	G1/4"	G1/4"	6,5	9,0	17	33,7	31,1	34,7
WTRHF10G03	10	G3/8"	G3/8"	7,5	10,0	19	39,7	31,6	51,3
WTRHF12G03	12	G3/8"	G3/8"	7,5	10,0	19	39,7	35,6	52,9
WTRHF12G04	12	G1/2"	G1/2"	9,0	12,0	24	45,0	36,6	77,3



**WTRHF-N**

Swivel female banjo elbow NPT & UNF thread nickel plated

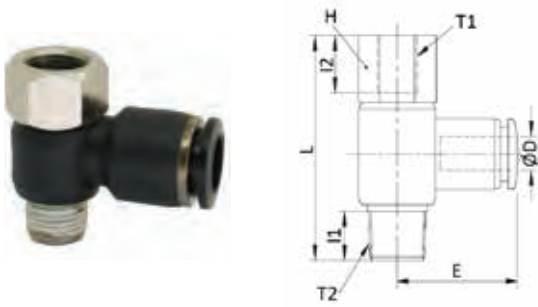

CODE	ØD	T1	T2	I1	I2	H	B	E	LB
WTRHF532UF1032	5/32	UNF 10-32	UNF 10-32	0,149	0,216	0,437	0,767	0,787	0,034
WTRHF532N01	5/32	N1/8"	N1/8"	0,295	0,295	0,562	1,181	0,877	0,036
WTRHF316UF1032	3/16	UNF 10-32	UNF 10-32	0,149	0,216	0,437	0,767	0,799	0,035
WTRHF316N01	3/16	N1/8"	N1/8"	0,295	0,295	0,562	1,181	0,889	0,037
WTRHF316N02	3/16	N1/4"	N1/4"	0,413	0,413	0,685	1,409	0,956	0,061
WTRHF1-4N01	1/4	N1/8"	N1/8"	0,295	0,295	0,562	1,181	0,909	0,037
WTRHF1-4N02	1/4	N1/4"	N1/4"	0,413	0,413	0,685	1,409	0,988	0,061
WTRHF516N01	5/16	N1/8"	N1/8"	0,295	0,295	0,562	1,181	1,007	0,039
WTRHF516N02	5/16	N1/4"	N1/4"	0,413	0,413	0,685	1,409	1,125	0,063
WTRHF516N03	5/16	N3/8"	N3/8"	0,433	0,433	0,874	1,610	1,165	0,100
WTRHF38N02	3/8	N1/4"	N1/4"	0,413	0,413	0,685	1,409	1,220	0,070
WTRHF38N03	3/8	N3/8"	N3/8"	0,433	0,433	0,874	1,610	1,244	0,107
WTRHF1-2N03	1/2	N3/8"	N3/8"	0,433	0,433	0,874	1,610	1,401	0,111
WTRHF1-2N04	1/2	N1/2"	N1/2"	0,551	0,551	1	1,929	1,440	0,170

**WTRT-R**

Swivel male central tee BSPT thread nickel plated

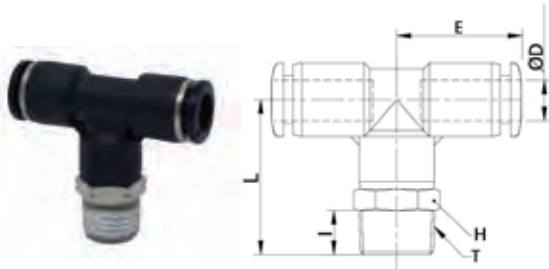

CODE	ØD	T	I	L	E	H	GR.
WTRT04R01	4	R1/8"	7,0	24,5	18,5	10	10,5
WTRT04R02	4	R1/4"	9,5	28,0	18,5	14	16,3
WTRT06R01	6	R1/8"	7,0	25,5	19,3	12	14,1
WTRT06R02	6	R1/4"	9,5	28,5	19,3	14	19,1
WTRT06R03	6	R3/8"	10,5	30,0	19,3	17	25,2
WTRT06R04	6	R1/2"	13,5	33,5	19,3	21	38,5
WTRT08R01	8	R1/8"	7,0	29,0	22,75	14	20,9
WTRT08R02	8	R1/4"	9,5	31,45	22,75	14	21,0
WTRT08R03	8	R3/8"	10,5	32,95	22,75	17	28,6
WTRT08R04	8	R1/2"	13,5	36,45	22,75	21	41,5
WTRT10R01	10	R1/8"	7,0	34,5	27,0	17	37,9
WTRT10R02	10	R1/4"	9,5	37,0	27,0	17	38,6
WTRT10R03	10	R3/8"	10,5	38,0	27,0	17	38,0
WTRT10R04	10	R1/2"	13,5	41,5	27,0	21	54,5
WTRT12R02	12	R1/4"	9,5	38,5	29,6	20	52,8
WTRT12R03	12	R3/8"	10,5	39,5	29,6	20	55,2
WTRT12R04	12	R1/2"	13,5	42,5	29,6	21	59,7
WTRT16R03	16	R3/8"	10,5	43,0	33,0	24	81,0
WTRT16R04	16	R1/2"	13,5	46,0	33,0	24	85,5



**WTRT-G**

Swivel male central tee BSPP & metric thread nickel plated

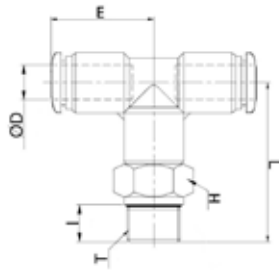

CODE	ØD	T	I	L	E	H	GR.
WTRT04M5	4	M5X0,8	3,8	22,3	18,5	10	10,6
WTRT04M6	4	M6X1	4,5	23,0	18,5	10	10,8
WTRT04G01	4	G1/8"	5,0	25,0	18,5	14	14,2
WTRT04G02	4	G1/4"	5,8	26,3	18,5	17	20,3
WTRT06M5	6	M5X0,8	3,8	23,3	19,3	12	13,9
WTRT06M6	6	M6X1	4,5	24,0	19,3	12	14,6
WTRT06G01	6	G1/8"	5,0	25,5	19,3	14	17,2
WTRT06G02	6	G1/4"	5,8	26,8	19,3	17	20,5
WTRT06G03	6	G3/8"	6,8	28,3	19,3	20	27,0
WTRT06G04	6	G1/2"	8,0	29,5	19,3	24	41,0
WTRT08G01	8	G1/8"	5,0	28,45	22,75	14	20,8
WTRT08G02	8	G1/4"	5,8	29,75	22,75	17	23,8
WTRT08G03	8	G3/8"	6,8	31,25	22,75	20	29,9
WTRT08G04	8	G1/2"	8,0	32,45	22,75	24	40,1
WTRT10G01	10	G1/8"	5,0	34,0	27,0	17	38,4
WTRT10G02	10	G1/4"	5,8	34,8	27,0	17	37,7
WTRT10G03	10	G3/8"	6,8	36,3	27,0	20	41,8
WTRT10G04	10	G1/2"	8,0	38,5	27,0	24	54,5
WTRT12G02	12	G1/4"	5,8	36,8	29,6	21	52,4
WTRT12G03	12	G3/8"	6,8	37,8	29,6	21	53,0
WTRT12G04	12	G1/2"	8,0	39,5	29,6	24	60,3
WTRT14G03	14	G3/8"	6,8	39,8	31,7	21	61,0
WTRT14G04	14	G1/2"	8,0	41,5	31,7	24	69,0
WTRT16G03	16	G3/8"	6,8	40,8	33,0	24	76,6
WTRT16G04	16	G1/2"	8,0	42,0	33,0	24	79,4



**WTRT-N**

Swivel male central tee NPT & UNF thread nickel plated

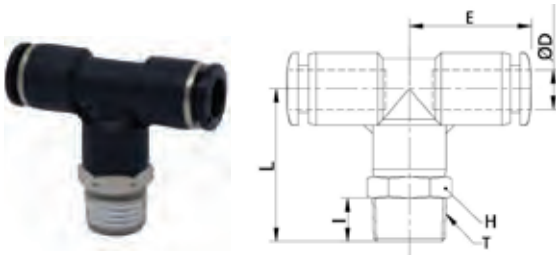

CODE	ØD	T	I	L	E	H	LB
WTRT532UF1032	5/32	UNF 10-32	0,149	0,905	0,728	0,437	0,022
WTRT532N01	5/32	N1/8"	0,295	0,984	0,728	0,437	0,023
WTRT532N02	5/32	N1/4"	0,413	1,141	0,728	0,562	0,036
WTRT316UF1032	3/16	UNF 10-32	0,149	0,905	0,740	0,437	0,028
WTRT316N01	3/16	N1/8"	0,295	1,003	0,740	0,437	0,029
WTRT316N02	3/16	N1/4"	0,413	1,141	0,740	0,562	0,040
WTRT316N03	3/16	N3/8"	0,433	1,181	0,740	0,685	0,052
WTRT1-4UF1032	1/4	UNF 10-32	0,149	0,972	0,759	0,5	0,029
WTRT1-4N01	1/4	N1/8"	0,295	1,023	0,759	0,5	0,031
WTRT1-4N02	1/4	N1/4"	0,413	1,161	0,759	0,562	0,042
WTRT1-4N03	1/4	N3/8"	0,433	1,200	0,759	0,685	0,055
WTRT516N01	5/16	N1/8"	0,295	1,159	0,895	0,562	0,046
WTRT516N02	5/16	N1/4"	0,413	1,277	0,895	0,562	0,046
WTRT516N03	5/16	N3/8"	0,433	1,316	0,895	0,685	0,063
WTRT38N01	3/8	N1/8"	0,295	1,377	1,062	0,685	0,083
WTRT38N02	3/8	N1/4"	0,413	1,496	1,062	0,685	0,085
WTRT38N03	3/8	N3/8"	0,433	1,515	1,062	0,685	0,083
WTRT38N04	3/8	N1/2"	0,551	1,653	1,062	0,874	0,120
WTRT1-2N02	1/2	N1/4"	0,413	1,555	1,165	0,874	0,116
WTRT1-2N03	1/2	N3/8"	0,433	1,574	1,165	0,874	0,121
WTRT1-2N04	1/2	N1/2"	0,551	1,692	1,165	0,874	0,131

**WTRST-R**

Swivel lateral male tee BSPT thread nickel plated

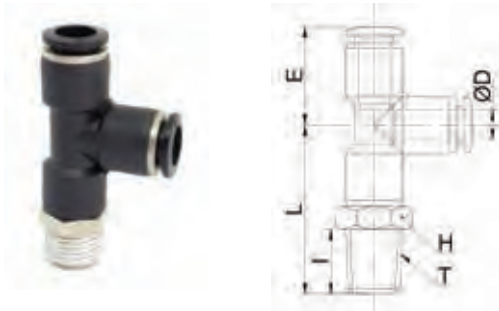

CODE	ØD	T	I	L	E	H	GR.
WTRST04R01	4	R1/8"	7,0	24,5	18,5	10	10,5
WTRST04R02	4	R1/4"	9,5	28,0	18,5	14	16,3
WTRST06R01	6	R1/8"	7,0	25,5	19,3	12	14,1
WTRST06R02	6	R1/4"	9,5	28,5	19,3	14	19,1
WTRST06R03	6	R3/8"	10,5	30,0	19,3	17	25,2
WTRST06R04	6	R1/2"	13,5	33,5	19,3	21	38,5
WTRST08R01	8	R1/8"	7,0	29,0	22,75	14	20,9
WTRST08R02	8	R1/4"	9,5	31,45	22,75	14	21,0
WTRST08R03	8	R3/8"	10,5	32,95	22,75	17	28,6
WTRST08R04	8	R1/2"	13,5	36,45	22,75	21	41,5
WTRST10R01	10	R1/8"	7,0	34,5	27,0	17	37,9
WTRST10R02	10	R1/4"	9,5	37,0	27,0	17	38,6
WTRST10R03	10	R3/8"	10,5	38,0	27,0	17	38,0
WTRST10R04	10	R1/2"	13,5	41,5	27,0	21	54,5
WTRST12R02	12	R1/4"	9,5	38,5	29,6	20	52,8
WTRST12R03	12	R3/8"	10,5	39,5	29,6	20	55,2
WTRST12R04	12	R1/2"	13,5	42,5	29,6	21	59,7



### WTRST-G

Swivel male lateral tee BSPP & metric thread nickel plated

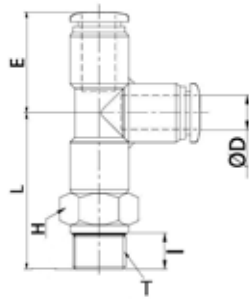

CODE	ØD	T	I	L	E	H	GR.
WTRST04M5	4	M5X0,8	3,8	22,3	18,5	10	10,6
WTRST04M6	4	M6X1	4,5	23,0	18,5	10	10,8
WTRST04G01	4	G1/8"	5,0	25,0	18,5	14	14,2
WTRST04G02	4	G1/4"	5,8	26,3	18,5	17	20,3
WTRST06M5	6	M5X0,8	3,8	23,3	19,3	12	13,9
WTRST06M6	6	M6X1	4,5	24,0	19,3	12	14,6
WTRST06G01	6	G1/8"	5,0	25,5	19,3	14	17,2
WTRST06G02	6	G1/4"	5,8	26,8	19,3	17	20,5
WTRST06G03	6	G3/8"	6,8	28,3	19,3	20	27,0
WTRST06G04	6	G1/2"	8,0	29,5	19,3	24	41,0
WTRST08G01	8	G1/8"	5,0	28,45	22,75	14	20,8
WTRST08G02	8	G1/4"	5,8	29,75	22,75	17	23,8
WTRST08G03	8	G3/8"	6,8	31,25	22,75	20	29,9
WTRST08G04	8	G1/2"	8,0	32,45	22,75	24	40,1
WTRST10G01	10	G1/8"	5,0	34,0	27,0	17	38,4
WTRST10G02	10	G1/4"	5,8	34,8	27,0	17	37,7
WTRST10G03	10	G3/8"	6,8	36,3	27,0	20	41,8
WTRST10G04	10	G1/2"	8,0	38,5	27,0	24	54,5
WTRST12G02	12	G1/4"	5,8	36,8	29,6	21	52,4
WTRST12R03	12	G3/8"	6,8	37,8	29,6	21	53,0
WTRST12G04	12	G1/2"	8,0	39,5	29,6	24	60,3

### WTRST-N

Swivel lateral male tee NPT & UNF nickel plated

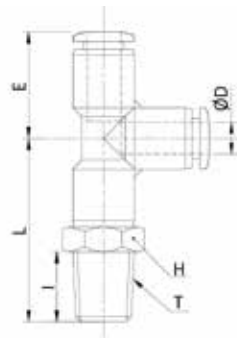

CODE	ØD	T	I	L	E	H	LB
WTRST532UF1032	5/32	UNF 10-32	0,149	0,905	0,728	0,437	0,022
WTRST532N01	5/32	N1/8"	0,295	0,984	0,728	0,437	0,023
WTRST532N02	5/32	N1/4"	0,413	1,141	0,728	0,562	0,036
WTRST316UF1032	3/16	UNF 10-32	0,149	0,905	0,740	0,437	0,029
WTRST316N01	3/16	N1/8"	0,295	1,003	0,740	0,437	0,031
WTRST316N02	3/16	N1/4"	0,413	1,141	0,740	0,562	0,040
WTRST316N03	3/16	N3/8"	0,433	1,181	0,740	0,685	0,052
WTRST1-4UF1032	1/4	UNF 10-32	0,149	0,972	0,759	0,5	0,031
WTRST1-4N01	1/4	N1/8"	0,295	1,023	0,759	0,5	0,032
WTRST1-4N02	1/4	N1/4"	0,413	1,161	0,759	0,562	0,042
WTRST1-4N03	1/4	N3/8"	0,433	1,200	0,759	0,685	0,055
WTRST516N01	5/16	N1/8"	0,295	1,159	0,895	0,562	0,046
WTRST516N02	5/16	N1/4"	0,413	1,277	0,895	0,562	0,046
WTRST516N03	5/16	N3/8"	0,433	1,316	0,895	0,685	0,063
WTRST38N01	3/8	N1/8"	0,295	1,377	1,062	0,685	0,083
WTRST38N02	3/8	N1/4"	0,413	1,496	1,062	0,685	0,085
WTRST38N03	3/8	N3/8"	0,433	1,515	1,062	0,685	0,083
WTRST38N04	3/8	N1/2"	0,551	1,653	1,062	0,874	0,120
WTRST1-2N02	1/2	N1/4"	0,413	1,555	1,165	0,874	0,116
WTRST1-2N03	1/2	N3/8"	0,433	1,574	1,165	0,874	0,121
WTRST1-2N04	1/2	N1/2"	0,551	1,692	1,165	0,874	0,131





**WTRWT-R**

Swivel male Y BSPT thread nickel plated

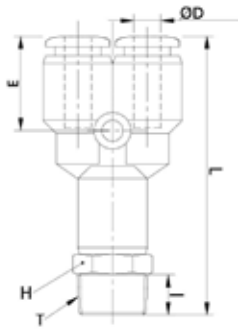

CODE	ØD	T	I	L	E	H	GR.
WTRWT04R01	4	R1/8"	7,0	41,5	14,0	10	10,7
WTRWT04R02	4	R1/4"	9,5	45,0	14,0	14	16,6
WTRWT06R01	6	R1/8"	7,0	43,3	14,8	12	14,6
WTRWT06R02	6	R1/4"	9,5	46,3	14,8	14	19,6
WTRWT06R03	6	R3/8"	10,5	47,8	14,8	17	25,8
WTRWT06R04	6	R1/2"	13,5	51,3	14,8	21	39,0
WTRWT08R01	8	R1/8"	7,0	46,6	18,2	14	21,0
WTRWT08R02	8	R1/4"	9,5	49,1	18,2	14	21,1
WTRWT08R03	8	R3/8"	10,5	50,6	18,2	17	28,7
WTRWT08R04	8	R1/2"	13,5	54,1	18,2	21	41,6
WTRWT10R01	10	R1/8"	7,0	54,6	19,5	17	38,3
WTRWT10R02	10	R1/4"	9,5	57,1	19,5	17	39,0
WTRWT10R03	10	R3/8"	10,5	58,1	19,5	17	38,4
WTRWT10R04	10	R1/2"	13,5	61,6	19,5	21	54,9
WTRWT12R02	12	R1/4"	9,5	62,1	21,6	21	53,6
WTRWT12R03	12	R3/8"	10,5	63,1	21,6	21	46,0
WTRWT12R04	12	R1/2"	13,5	66,1	21,6	21	60,5

**WTRWT-G**

Swivel male Y BSPP & metric thread nickel plated

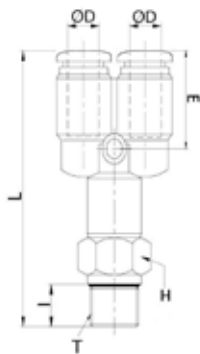

CODE	ØD	T	I	L	E	H	GR.
WTRWT04M5	4	M5X0,8	4,0	18,0	14,0	10	10,8
WTRWT04M6	4	M6X1	4,5	18,5	14,0	10	11,0
WTRWT04G01	4	G1/8"	5,0	42,0	14,0	14	14,5
WTRWT04G02	4	G1/4"	5,8	43,3	14,0	17	20,6
WTRWT06M5	6	M5X0,8	4,0	41,1	14,8	12	14,5
WTRWT06M6	6	M6X1	4,5	41,8	14,8	12	15,1
WTRWT06G01	6	G1/8"	5,0	43,3	14,8	14	17,7
WTRWT06G02	6	G1/4"	5,8	44,6	14,8	17	21,0
WTRWT06G03	6	G3/8"	6,8	46,1	14,8	20	27,5
WTRWT06G04	6	G1/2"	8,0	47,3	14,8	24	41,5
WTRWT08G01	8	G1/8"	5,0	46,1	18,2	14	20,9
WTRWT08G02	8	G1/4"	5,8	47,4	18,2	17	23,9
WTRWT08G03	8	G3/8"	6,8	48,9	18,2	20	30,0
WTRWT08G04	8	G1/2"	8,0	50,1	18,2	24	40,2
WTRWT10G01	10	G1/8"	5,0	54,1	19,5	17	38,8
WTRWT10G02	10	G1/4"	5,8	54,9	19,5	17	38,1
WTRWT10G03	10	G3/8"	6,8	56,4	19,5	20	42,2
WTRWT10G04	10	G1/2"	8,0	58,6	19,5	24	54,9
WTRWT12G02	12	G1/4"	5,8	60,4	21,6	21	53,2
WTRWT12G03	12	G3/8"	6,8	61,4	21,6	21	53,8
WTRWT12G04	12	G1/2"	8,0	63,1	21,6	24	61,1



**WTRWT-N**

Swivel male Y NPT & UNF thread nickel plated

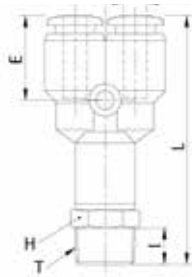

CODE	ØD	T	I	L	E	H	LB
WTRWT532UF1032	5/32	UNF 10-32	0,149	1,574	0,551	0,437	0,022
WTRWT532N01	5/32	N1/8"	0,295	1,653	0,551	0,437	0,023
WTRWT532N02	5/32	N1/4"	0,413	1,811	0,551	0,562	0,036
WTRWT316UF1032	3/16	UNF 10-32	0,149	1,586	0,562	0,437	0,030
WTRWT316N01	3/16	N1/8"	0,295	0,593	0,562	0,437	0,032
WTRWT316N02	3/16	N1/4"	0,413	1,822	0,562	0,562	0,041
WTRWT316N03	3/16	N3/8"	0,433	1,862	0,562	0,685	0,054
WTRWT1-4UF1032	1/4	UNF 10-32	0,149	1,673	0,582	0,5	0,031
WTRWT1-4N01	1/4	N1/8"	0,295	1,724	0,582	0,5	0,032
WTRWT1-4N02	1/4	N1/4"	0,413	1,862	0,582	0,562	0,043
WTRWT1-4N03	1/4	N3/8"	0,433	1,901	0,582	0,685	0,056
WTRWT516N01	5/16	N1/8"	0,295	1,854	0,716	0,562	0,046
WTRWT516N02	5/16	N1/4"	0,413	1,972	0,716	0,562	0,046
WTRWT516N03	5/16	N3/8"	0,433	2,011	0,716	0,685	0,063
WTRWT38N01	3/8	N1/8"	0,295	2,169	0,767	0,685	0,084
WTRWT38N02	3/8	N1/4"	0,413	2,287	0,767	0,685	0,085
WTRWT38N03	3/8	N3/8"	0,433	2,307	0,767	0,685	0,084
WTRWT38N04	3/8	N1/2"	0,551	2,444	0,767	0,874	0,121
WTRWT1-2N02	1/2	N1/4"	0,413	2,484	0,850	0,874	0,118
WTRWT1-2N03	1/2	N3/8"	0,433	2,503	0,850	0,874	0,101
WTRWT1-2N04	1/2	N1/2"	0,551	2,622	0,850	0,874	0,133

**WTRKD-R**

Swivel multi-tee lateral male connector BSPT thread nickel plated

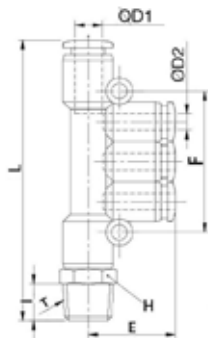

CODE	ØD1	ØD2	T	E	F	L	I	H	GR.
WTRKD0604R01	6	4	R1/8"	19,0	36	63,8	7,0	12	17,4
WTRKD0804R02	8	4	R1/4"	20,0	42	71,3	9,5	14	23,1
WTRKD0806R02	8	6	R1/4"	20,3	42	71,3	9,5	14	24,2
WTRKD1008R03	10	8	R3/8"	24,3	48	91,0	10,5	17	40,2

**WTRKD-G**

Swivel multi-tee lateral male connector BSPP thread nickel plated

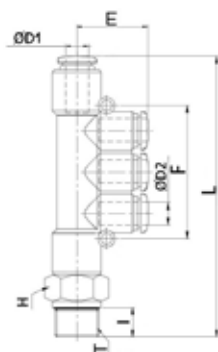

CODE	ØD1	ØD2	T	E	F	L	I	H	GR.
WTRKD0604G01	6	4	G1/8"	19,0	36	63,8	5,0	14	20,5
WTRKD0804G02	8	4	G1/4"	20,0	42	69,6	5,8	17	26,0
WTRKD0806G02	8	6	G1/4"	20,3	42	69,6	5,8	17	27,0
WTRKD1008G03	10	8	G3/8"	24,3	48	89,3	6,8	20	44,0



**WTRKD-N**

Swivel multi-tee lateral male connector NPT thread nickel plated

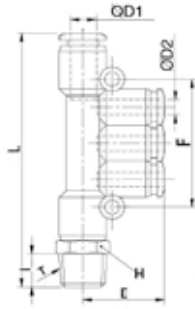

CODE	ØD1	ØD2	H	T	E	F	L	I	LB
WTRKD316-532N01	3/16	5/32	0,437	N1/8"	0,748	1,417	2,531	0,295	0,036
WTRKD1-4-532N01	1/4	5/32	0,5	N1/8"	0,748	1,417	2,531	0,295	0,048
WTRKD516-532N02	5/16	5/32	0,562	N1/4"	0,787	1,653	2,846	0,413	0,050
WTRKD516-316N02	5/16	3/16	0,562	N1/4"	0,799	1,653	2,846	0,413	0,050
WTRKD516-1-4N02	5/16	1/4	0,562	N1/4"	0,799	1,653	2,846	0,413	0,053
WTRKD38-516N03	3/8	5/16	0,685	N3/8"	0,956	1,889	3,602	0,433	0,088

**WTRUC**

Union connector

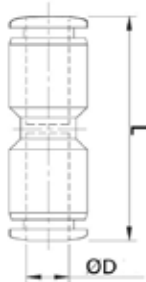

CODE	ØD	L	GR.
WTRUC0400	4	33,0	4,2
WTRUC0500	5	35,2	5,0
WTRUC0600	6	35,2	5,2
WTRUC0700	7	39,1	7,0
WTRUC0800	8	39,1	6,8
WTRUC0900	9	45,2	14,0
WTRUC1000	10	45,2	14,0
WTRUC1100	11	49,2	17,0
WTRUC1200	12	49,2	16,4
WTRUC1400	14	48,4	18,0
WTRUC1500	15	51,0	25,0
WTRUC1600	16	51,0	24,5

**WTRUC-N**

Union connector

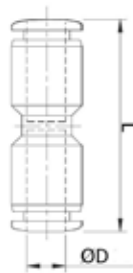

CODE	ØD	L	LB
WTRUC532	5/32	1,299	0,009
WTRUC316	3/16	1,322	0,010
WTRUC1-4	1/4	1,385	0,011
WTRUC516	5/16	1,539	0,014
WTRUC38	3/8	1,779	0,030
WTRUC1-2	1/2	1,937	0,036



**WTRG**

Reduced union connector

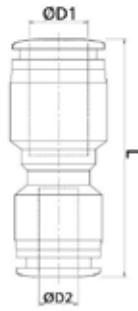

CODE	ØD1	ØD2	L	GR.
WTRG0604	6	4	33,6	5,2
WTRG0805	8	5	35,5	6,0
WTRG0806	8	6	36,1	6,8
WTRG1007	10	7	41,8	10,0
WTRG1008	10	8	41,8	12,7
WTRG1207	12	7	46,9	13,0
WTRG1208	12	8	46,9	14,1
WTRG1210	12	10	46,1	16,6
WTRG1410	14	10	46,7	17,0
WTRG1412	14	12	48,3	17,0
WTRG1610	16	10	48,5	24,3
WTRG1612	16	12	50,1	26,0
WTRG1614	16	14	50	28,0

**WTRG-N**

Reduced union connector

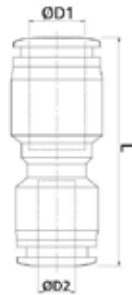

CODE	ØD1	ØD2	L	LB
WTRG316-532	3/16	5/32	1,311	0,014
WTRG1-4-532	1/4	5/32	1,374	0,010
WTRG1-4-316	1/4	3/16	1,385	0,011
WTRG516-1-4	5/16	1/4	1,519	0,014
WTRG38-516	3/8	5/16	1,862	0,027
WTRG1-2-38	1/2	3/8	1,925	0,036

**WTRUL**

Union elbow

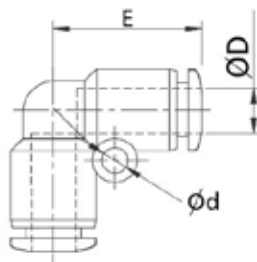

CODE	ØD	ØD	E	GR.
WTRUL0400	4	3,2	17,5	4,2
WTRUL0600	6	3,2	19,0	5,5
WTRUL0800	8	3,2	22,8	7,3
WTRUL1000	10	4,2	26,3	14,3
WTRUL1200	12	4,3	29,6	18,2
WTRUL1400	14	5,1	31,7	23,0
WTRUL1600	16	5,1	33,0	27,0



**WTRUL-N**

Union elbow

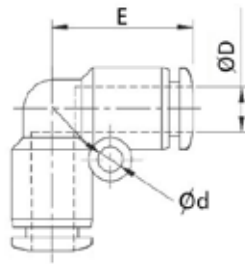

CODE	ØD	Ød	E	LB
WTRUL532	5/32	0,125	0,688	0,009
WTRUL316	3/16	0,125	0,700	0,011
WTRUL1-4	1/4	0,125	0,748	0,012
WTRUL516	5/16	0,125	0,897	0,016
WTRUL38	3/8	0,165	1,035	0,031
WTRUL1-2	1/2	0,169	1,165	0,040

**WTRUT**

Union tee

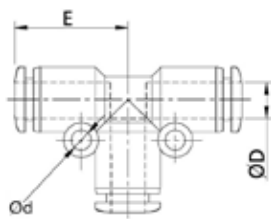

CODE	ØD	Ød	E	GR.
WTRUT0400	4	3,2	18,5	6,5
WTRUT0600	6	3,2	19,3	8,1
WTRUT0800	8	3,2	22,75	10,6
WTRUT1000	10	4,2	27,0	21,4
WTRUT1200	12	4,3	29,6	26,7
WTRUT1400	14	5,1	31,7	31,0
WTRUT1600	16	5,1	33,0	39,7

**WTRUT-N**

Union tee

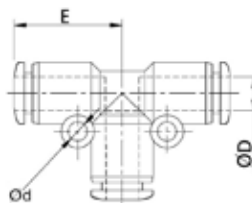

CODE	ØD	Ød	E	LB
WTRUT532	5/32	0,125	0,728	0,014
WTRUT316	3/16	0,125	0,740	0,016
WTRUT1-4	1/4	0,125	0,759	0,017
WTRUT516	5/16	0,125	0,895	0,023
WTRUT38	3/8	0,165	1,062	0,047
WTRUT1-2	1/2	0,169	1,165	0,058

**WTRGT**

Reduced union tee

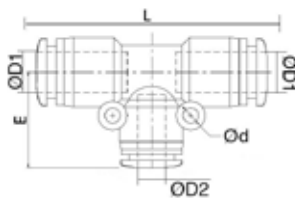

CODE	ØD1	ØD2	Ød	E	L	GR.
WTRGT0604	6	4	3,2	19,5	38,6	8,1
WTRGT0806	8	6	3,2	20,3	45,5	10,6
WTRGT1008	10	8	4,2	24,8	54,0	20,2
WTRGT1210	12	10	4,2	28,5	59,2	26,9
WTRGT1612	16	12	5,1	32,1	66,0	41,9



**WTRGT-N**

Reduced union tee

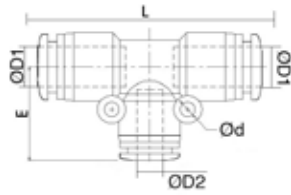

CODE	ØD1	ØD2	ØD	L	E	LB
WTRGT1-4-532	1/4	5/32	0,125	1,518	0,748	0,016
WTRGT516-1-4	5/16	1/4	0,125	1,79	0,877	0,023
WTRGT38-516	3/8	5/16	0,125	2,124	1,094	0,044
WTRGT1-2-38	1/2	3/8	0,165	2,33	1,153	0,059

**WTRY**

Union Y

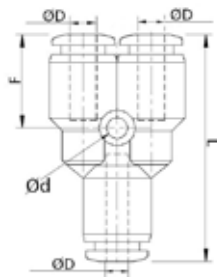

CODE	ØD	Ød	L	F	GR.
WTRY0400	4	3,2	35,5	14,0	6,8
WTRY0600	6	3,2	37,1	14,8	8,6
WTRY0800	8	3,2	40,4	18,2	10,7
WTRY1000	10	4,2	47,1	19,5	21,8
WTRY1200	12	4,2	53,2	21,6	27,5
WTRY1600	16	5,1	61,0	23,5	33,5

**WTRY-N**

Union Y

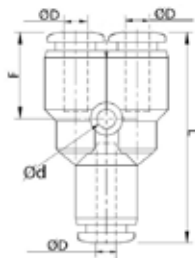

CODE	ØD	Ød	L	F	LB
WTRY532	5/32	0,125	1,397	0,551	0,014
WTRY316	3/16	0,125	1,421	0,562	0,018
WTRY1-4	1/4	0,125	1,460	0,582	0,019
WTRY516	5/16	0,125	1,590	0,716	0,023
WTRY38	3/8	0,165	1,854	0,767	0,048
WTRY1-2	1/2	0,165	2,094	0,850	0,060

**WTRW**

Reduced union Y

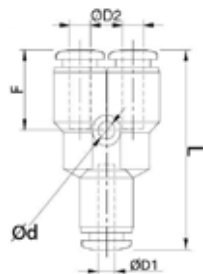

CODE	ØD1	ØD2	Ød	L	F	GR.
WTRW0604	6	4	3,2	36,8	14,5	9,2
WTRW0806	8	6	3,2	39,9	17,7	11,4
WTRW1008	10	8	4,2	47,9	20,3	21,8
WTRW1210	12	10	4,2	51,6	20,0	29,3



**WTRW-N**

Reduced union Y

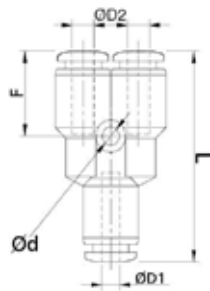

CODE	ØD1	ØD2	Ød	L	F	LB
WTRW316-532	3/16	5/32	0,125	1,409	0,551	0,019
WTRW1-4-532	1/4	5/32	0,125	1,448	0,570	0,020
WTRW1-4-316	1/4	3/16	0,125	1,460	0,582	0,021
WTRW516-1-4	5/16	1/4	0,125	1,570	0,696	0,025
WTRW38-516	3/8	5/16	0,165	1,885	0,799	0,048
WTRW1-2-38	1/2	3/8	0,165	2,031	0,787	0,064

**WTRZA**

Union cross

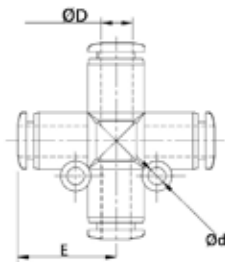

CODE	ØD	Ød	E	GR.
WTRZA0400	4	3,2	17,5	8,0
WTRZA0600	6	3,2	19,3	10,2
WTRZA0800	8	3,2	22,75	13,6
WTRZA1000	10	4,2	27,0	28,2
WTRZA1200	12	4,3	29,6	34,2

**WTRZA-N**

Union cross

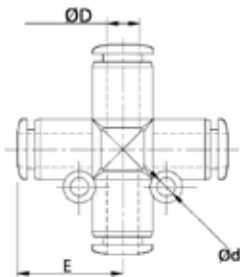

CODE	ØD	Ød	E	LB
WTRZA532	5/32	0,125	0,688	0,017
WTRZA316	3/16	0,125	0,700	0,021
WTRZA1-4	1/4	0,125	0,759	0,022
WTRZA516	5/16	0,125	0,895	0,029
WTRZA38	3/8	0,165	1,062	0,062
WTRZA1-2	1/2	0,169	1,165	0,075

**WTRK**

Union multi tee

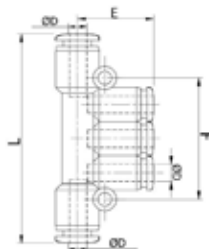

CODE	ØD	F	E	L	GR.
WTRK04	4	36	19	57,0	13,0
WTRK06	6	42	20,3	61,6	17,0
WTRK08	8	48	24,3	81,6	22,0



**WTRK-N**

Union multi tee

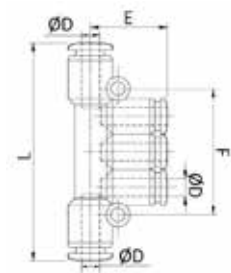

CODE	ØD	F	E	L	LB
WTRK532	5/32	1,417	0,748	2,244	0,028
WTRK316	3/16	1,417	0,759	2,267	0,035
WTRK1-4	1/4	1,653	0,799	2,425	0,037
WTRK516	5/16	1,889	0,956	3,173	0,048

**WTRKG**

Reduced union multi tee

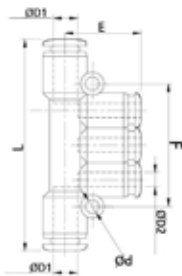

CODE	ØD1	ØD2	ØD	E	F	L	GR.
WTRKG0604	6	4	3,2	19,0	36	57,6	13,0
WTRKG0804	8	4	3,2	20,0	42	62,6	16,0
WTRKG0806	8	6	3,2	20,3	42	62,6	16,6
WTRKG1006	10	6	4,2	23,8	48	80,0	28,0
WTRKG1008	10	8	4,2	24,3	48	80,0	30,8

**WTRKG-N**

Reduced union multi tee

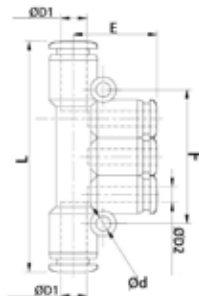

CODE	ØD1	ØD2	E	F	L	LB
WTRKG316-532	3/16	5/32	0,748	1,417	2,267	0,027
WTRKG1-4-532	1/4	5/32	0,748	1,417	2,267	0,028
WTRKG516-532	5/16	5/32	0,787	1,653	2,464	0,035
WTRKG516-1-4	5/16	1/4	0,799	1,653	2,464	0,036
WTRKG38-1-4	3/8	1/4	0,937	1,889	3,149	0,061
WTRKG38-516	3/8	5/16	0,956	1,889	3,149	0,067

**WTRGJ**

Reducer



CODE	ØD1	ØD2	L	GR.
WTRGJ0604	6	4	39,5	1,4
WTRGJ0804	8	4	41,5	2,7
WTRGJ0806	8	6	41,8	2,0
WTRGJ1006	10	6	46,8	3,8
WTRGJ1008	10	8	47,3	2,8
WTRGJ1206	12	6	51,8	7,7
WTRGJ1208	12	8	52,3	6,4
WTRGJ1210	12	10	51,5	4,2





**WTRGJ-N**

Reducer

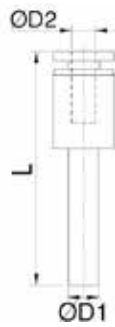

CODE	ØD1	ØD2	L	IB
WTRGJ1-4-532	1/4	5/32	1,555	0,003
WTRGJ516-532	5/16	5/32	1,633	0,005
WTRGJ516-1-4	5/16	1/4	1,645	0,004
WTRGJ38-1-4	3/8	1/4	1,830	0,008
WTRGJ38-516	3/8	5/16	1,830	0,006
WTRGJ1-2-1-4	1/2	1/4	2,039	0,016
WTRGJ1-2-516	1/2	5/16	2,059	0,014
WTRGJ1-2-38	1/2	3/8	2,027	0,009

**WTRLJ**

Elbow with stem

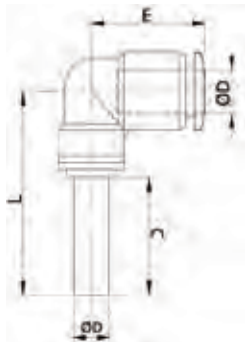

CODE	ØD	C	E	L	GR.
WTRLJ0400	4	16,0	17,5	33,0	6,5
WTRLJ0600	6	18,0	19,0	36,2	8,1
WTRLJ0800	8	21,0	22,8	40,0	10,6
WTRLJ1000	10	24,0	26,3	46,5	21,4
WTRLJ1200	12	26,0	29,6	51,5	26,7

**WTRLJ-N**

Elbow with stem

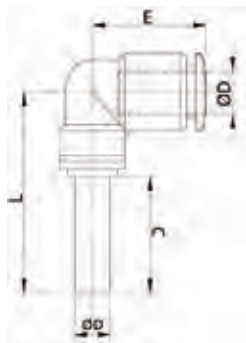

CODE	ØD	L	E	LB
WTRLJ532	5/32	1,299	0,688	0,014
WTRLJ316	3/16	1,299	0,700	0,016
WTRLJ1-4	1/4	1,425	0,748	0,017
WTRLJ516	5/16	1,673	0,897	0,023
WTRLJ38	3/8	2	1,035	0,047
WTRLJ1-2	1/2	2,145	1,165	0,058

**WTRLGJ**

Reduced elbow with stem

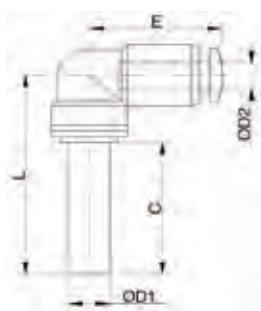

CODE	ØD1	ØD2	E	C	L	GR.
WTRLGJ0604	6	4	17,5	18,0	35,0	8,7
WTRLGJ0806	8	6	19,0	21,0	39,2	13,7
WTRLGJ1008	10	8	22,8	24,0	44,0	19,4
WTRLGJ1210	12	10	26,3	26,0	48,5	34,6



**WTRLGJ-N**

Reduced elbow with stem

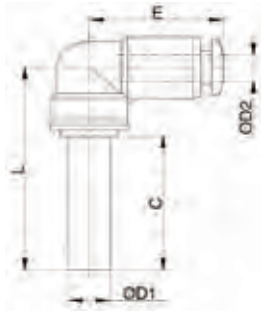

CODE	ØD1	ØD2	L	E	LB
WTRLGJ316-532	3/16	5/32	1,299	0,688	0,018
WTRLGJ1-4-532	1/4	5/32	1,377	0,688	0,019
WTRLGJ1-4-316	1/4	3/16	1,377	0,688	0,020
WTRLGJ516-1-4	5/16	1/4	1,543	0,748	0,030
WTRLGJ38-516	3/8	5/16	1,673	0,897	0,042
WTRLGJ1-2-38	1/2	3/8	2,078	1,035	0,076

**WTRYJ**

Union Y with stem

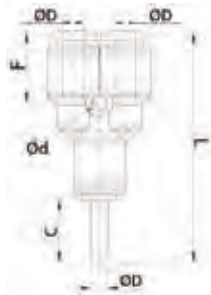

CODE	ØD	Ød	L	F	C	GR.
WTRYJ0400	4	3,2	51,0	14,0	16,0	10,2
WTRYJ0600	6	3,2	54,3	14,8	18,0	14,4
WTRYJ0800	8	3,2	60,1	18,2	21,0	20,4
WTRYJ1000	10	4,2	71,6	19,5	24,0	38,1
WTRYJ1200	12	4,2	78,1	21,6	26,0	49,9

**WTRYJ-N**

Union Y with stem

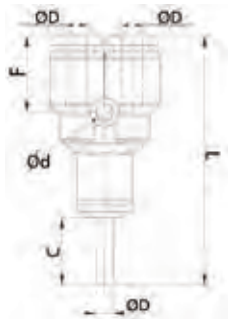

CODE	ØD	ØD	L	F	LB
WTRYJ532	5/32	0,125	2,007	0,551	0,022
WTRYJ316	3/16	0,125	2,019	0,562	0,030
WTRYJ1-4	1/4	0,125	2,137	0,582	0,031
WTRYJ516	5/16	0,125	2,366	0,716	0,044
WTRYJ38	3/8	0,165	2,818	0,767	0,083
WTRYJ1-2	1/2	0,165	3,074	0,850	0,11

**WTRWJ**

Reduced union Y with stem

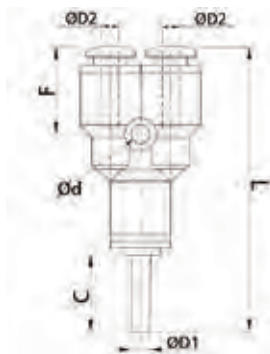

CODE	ØD1	ØD2	Ød	L	F	C	GR.
WTRWJ0604	6	4	3,2	53,0	14,0	18,0	14,5
WTRWJ0806	8	6	3,2	57,3	14,8	21,0	20,4
WTRWJ1008	10	8	4,2	64,1	18,2	24,0	35,5
WTRWJ1210	12	10	4,2	73,6	19,5	26,0	50,5



**WTRWJ-N**

Reduced union Y with stem

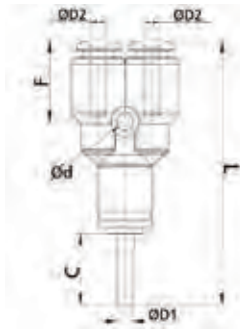

CODE	ØD1	ØD2	ØD	L	F	LB
WTRWJ1-4-532	1/4	5/32	0,125	2,086	0,551	0,031
WTRWJ516-1-4	5/16	1/4	0,125	2,255	0,582	0,044
WTRWJ38-516	3/8	5/16	0,165	2,523	0,716	0,078
WTRWJ1-2-38	1/2	3/8	0,165	2,897	0,767	0,111

**WTRKJ**

Multi-tee union with lateral stem

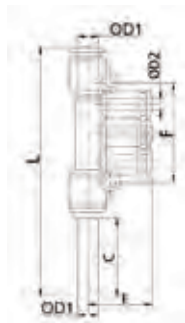

CODE	ØD1	ØD2	E	F	C	L	GR.
WTRKJ0604	6	4	19,0	36	18	74,8	4,2
WTRKJ0804	8	4	20,0	42	21	82,3	5,5
WTRKJ0806	8	6	20,3	42	21	82,3	7,3
WTRKJ1006	10	6	23,8	48	24	104,5	14,3
WTRKJ1008	10	8	24,3	48	24	104,5	18,2

**WTRKJ-N**

Multi-tee union with lateral stem

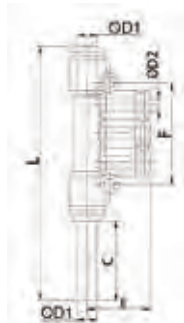

CODE	ØD1	ØD2	E	F	L	LB
WTRKJ316-532	3/16	5/32	0,748	1,417	2,866	0,008
WTRKJ1-4-532	1/4	5/32	0,748	1,417	2,944	0,009
WTRKJ516-532	5/16	5/32	0,787	1,653	3,240	0,012
WTRKJ516-1-4	5/16	1/4	0,799	1,653	3,240	0,016
WTRKJ38-1-4	3/8	1/4	0,937	1,889	4,114	0,031
WTRKJ38-516	3/8	5/16	0,956	1,889	4,115	0,040

**WTRPF**

Female plug

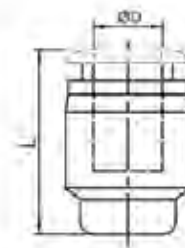

CODE	ØD	L	GR.
WTRPF04	4	17,5	2,6
WTRPF05	5	17,5	3,1
WTRPF06	6	17,5	3,7
WTRPF07	7	20,8	3,8
WTRPF08	8	20,8	4,2
WTRPF10	10	25,3	5,5
WTRPF12	12	25,6	9,3
WTRPF14	14	25,7	12,4
WTRPF15	15	27,0	15,3
WTRPF16	16	27,0	17,1



**WTRIJ**

Junction



CODE	ØD	L	GR.
WTRIJ04	4	35	0,4
WTRIJ06	6	37	0,8
WTRIJ08	8	41	1,2
WTRIJ10	10	51	2,7
WTRIJ12	12	54	3,5
WTRIJ16	16	58	5,3

**WTRIJ-N**

Junction



CODE	ØD	L	LB
WTRIJ532	5/32	1,377	0,008
WTRIJ316	3/16	1,377	0,016
WTRIJ1-4	1/4	1,456	0,001
WTRIJ516	5/16	1,614	0,002
WTRIJ38	3/8	2,007	0,005
WTRIJ1-2	1/2	2,125	0,007

**WTRIG**

Reduced junction

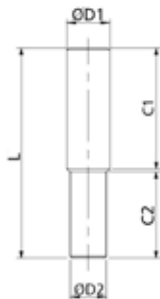

CODE	ØD1	ØD2	C1	C2	L	GR.
WTRIG0604	6	4	18	17	36	0,6
WTRIG0806	8	6	20	18	39	1,0
WTRIG1008	10	8	25	20	46	1,9
WTRIG1210	12	10	27	26	54	3,2
WTRIG1612	16	12	28	28	56	4,8

**WTRIG-N**

Reduced junction

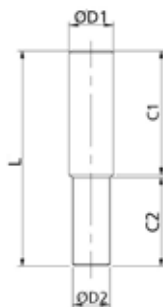

CODE	ØD1	ØD2	C1	C2	L	LB
WTRIG316-532	3/16	5/32	0,708	0,669	1,417	0,001
WTRIG1-4-532	1/4	5/32	0,708	0,669	1,417	0,001
WTRIG1-4-316	1/4	3/16	0,708	0,669	1,417	0,001
WTRIG516-1-4	5/16	1/4	0,787	0,708	1,535	0,002
WTRIG38-516	3/8	5/16	0,984	0,787	1,811	0,004
WTRIG1-2-38	1/2	3/8	1,062	1,023	2,125	0,007



**WTRP**

Male plug

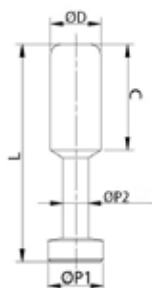

CODE	ØD	L	ØP1	ØP2	C	GR.
WTRP04	4	28	5,0	3,0	15,0	0,4
WTRP06	6	33	7,0	3,0	17,0	0,8
WTRP08	8	37	9,0	4,0	18,0	1,3
WTRP10	10	42	11,0	5,0	20,5	2,2
WTRP12	12	44	13,0	6,0	23,0	3,1

**WTRP-N**

Male plug

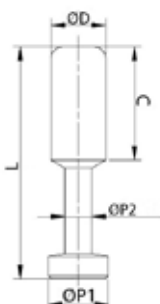

CODE	ØD	L	ØP1	ØP2	C	LB
WTRP532	5/32	1,102	0,196	0,118	0,590	0,0008
WTRP316	3/16	1,102	0,196	0,118	0,590	0,0016
WTRP1-4	1/4	1,299	0,275	0,118	0,669	0,0017
WTRP516	5/16	1,456	0,354	0,157	0,708	0,0028
WTRP38	3/8	1,653	0,433	0,196	0,807	0,0048
WTRP1-2	1/2	1,732	0,511	0,236	0,905	0,0068

**WTRUC-PRD**

Union connector for DIN profile ( o Ω)

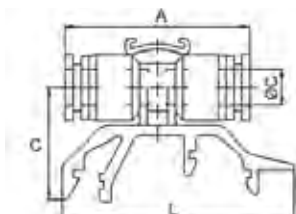





CODE	ØD	A	L	C	GR.
WTRUC-PRD04	4	34,6	45,0	22,0	8,0
WTRUC-PRD06	6	35,2	45,0	22,0	8,0
WTRUC-PRD08	8	39,1	45,0	22,7	10,0
WTRUC-PRD10	10	45,2	45,0	24,7	17,0

**WTRCV**

Applicable sleeve

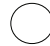

CODE	ØD						GR.
WTRCV04	4	WTRCV04BL	WTRCV04RO	WTRCV04BO	WTRCV04GL	WTRCV04VD	0,10
WTRCV06	6	WTRCV06BL	WTRCV06RO	WTRCV06BO	WTRCV06GL	WTRCV06VD	0,14

**TR**

Push-in fittings with barb connector

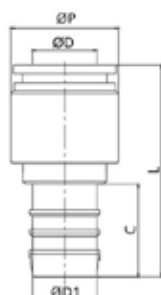

CODE	ØD	ØD1	ØP	C	L	GR.
TR1213P	12	1/2	20,0	10,8	40,8	24,0



